

DRAWING DISCLAIMER

COPYRIGHT OF THIS DRAWING IS RESERVED BY BIL GROUP LTD. IT IS ISSUED ON CONDITION THAT IT IS NOT REPRODUCED, COPIED, OR DISCLOSED TO A THIRD PARTY EITHER WHOLLY OR IN PART WITHOUT THE CONSENT IN WRITING OF BIL GROUP LTD.

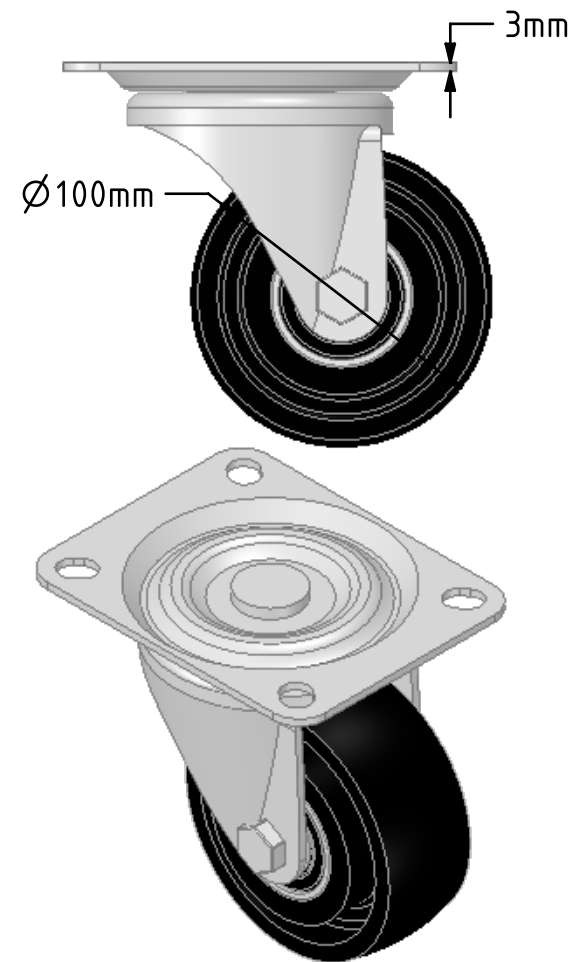
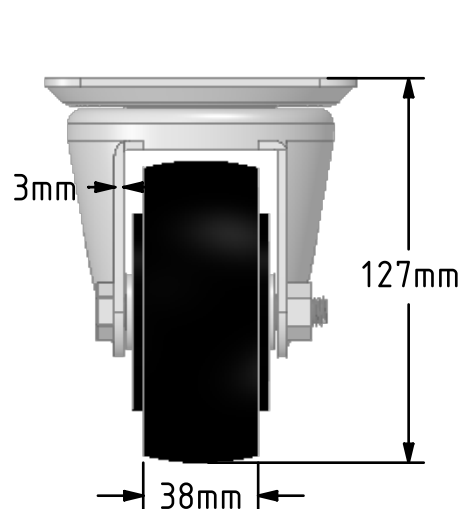
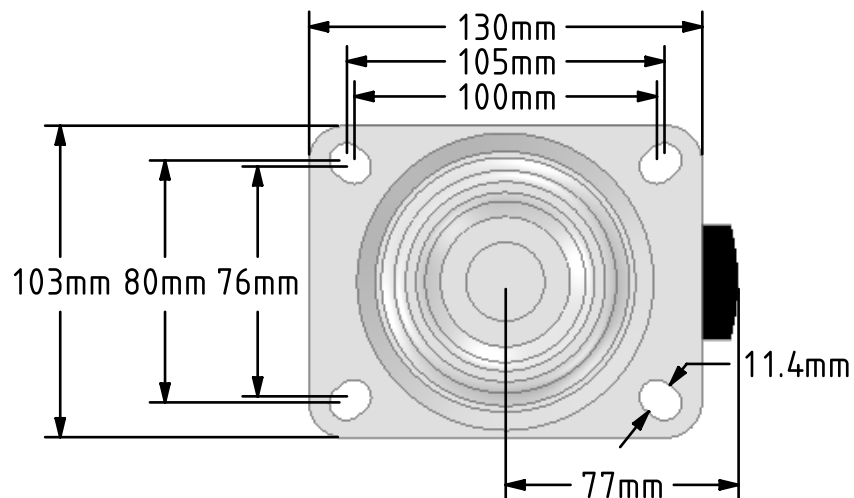

Description:

BZH100CIBJLP

Pressed steel swivel castor with a top plate fixing fitted with a solid cast iron wheel with ball bearings. Wheel diameter 100mm, tread width 38mm, overall height 127mm, top plate 130mm x 103mm, hole centres 105mm x 80mm or 100mm x 76mm. Load capacity 250kg.



	NAME	DATE
DRAWN	Matt	19/09/18
APPROVED BY	Chris	19/09/18
SCALE	2:5	19/09/18
WEIGHT	2.439kg	19/09/18

UNLESS OTHERWISE SPECIFIED DIMENSIONS ARE IN MILLIMETRES

Unspecified Tolerances
Machining $\pm 0.25\text{mm}$
Fabrication $\pm 1\text{mm}$



BIL Group Ltd, Porte Marsh Road, Calne
Wiltshire, SN11 9BW, United Kingdom
Tel +44 (0)1249 822 222 Fax: +44 (0)1249 822 300
www.bilgroup.co.uk

TITLE

BZH100CIBJLP

SIZE DWG NO.

A4

BILCW03BZH100CIBJLP__01

REV
1

FILE NAME

BILCW03BZH100CIBJLP__01.PDF

SHEET 1 OF 1