

ITEM NO.	PART NUMBER	QTY
1	BZSPH150ASFPSWB	1
2	BZMH150WSRNBJM15	1
3	AXLE KIT	
	TH15X5X12	2
	HEXBOLTM12X90Z8.8	1
	NYLOCM12Z14MM	1

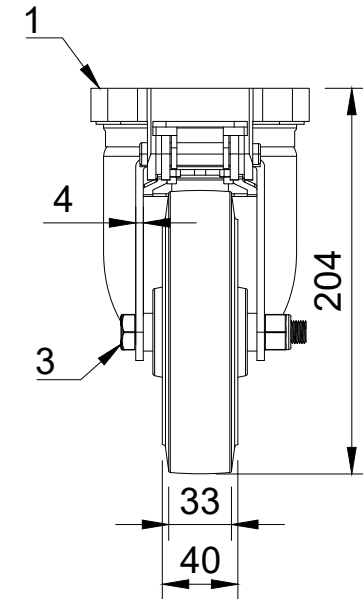

UNLESS OTHERWISE SPECIFIED DIMENSIONS ARE IN MILLIMETRES

Unspecified Tolerances  
Machining ± 0.25mm  
Fabrication ± 1mm

DRAWING DISCLAIMER

COPYRIGHT OF THIS DRAWING IS RESERVED BY BIL GROUP LTD. IT IS NOT REPRODUCED, COPIED, OR DISCLOSED TO A THIRD PARTY EITHER WHOLLY OR IN PART WITHOUT THE CONSENT IN WRITING OF BIL GROUP LTD

	NAME	DATE
DRAWN BY	Matt	09/11/23
APPROVED BY	Kevin	09/11/23
SCALE	1:4	
WEIGHT		

**BILGroup**

BIL Group Ltd  
Porte Marsh Road  
Calne, Wiltshire, SN11 9BW  
United Kingdom  
Tel +44 (0)1249 822 222  
www.bilgroup.co.uk

DWG NO.	REV
BZSPH150SRNBJFPSWB	1
BZSPH150SRNBJFPSWB SHEET 1 OF 1	