

ITEM NO.	PART NUMBER	QTY
1	NTW75TPRBJBH12SWB	1
2	STEM	
	TUBEM12X40X10	1
	WM10X21X2	2
	HEXBOLTM10X70Z8.8	1
	NM10GR8FULLZHT	1

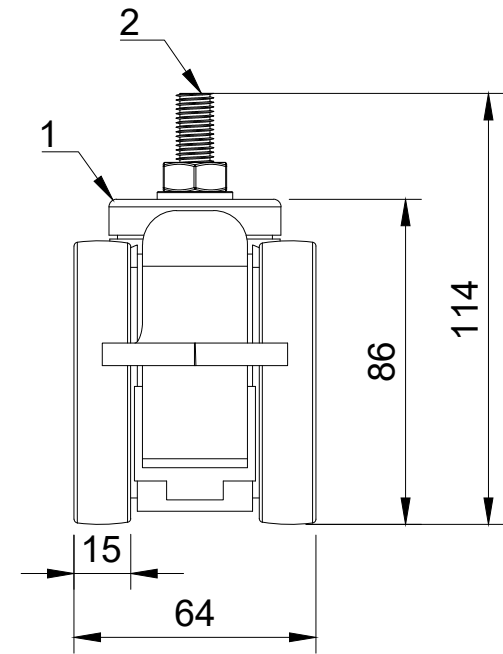

UNLESS OTHERWISE SPECIFIED DIMENSIONS ARE IN MILLIMETRES

Unspecified Tolerances
Machining ± 0.25mm
Fabrication ± 1mm

DRAWING DISCLAIMER

COPYRIGHT OF THIS DRAWING IS RESERVED BY BIL GROUP LTD. IT IS NOT REPRODUCED, COPIED, OR DISCLOSED TO A THIRD PARTY EITHER WHOLLY OR IN PART WITHOUT THE CONSENT IN WRITING OF BIL GROUP LTD

	NAME	DATE
DRAWN BY	Matt	10/11/23
APPROVED BY	Kevin	10/11/23
SCALE	1:2	
WEIGHT	0.418kg	

BILGroup

BIL Group Ltd
Porte Marsh Road
Calne, Wiltshire, SN11 9BW
United Kingdom
Tel +44 (0)1249 822 222
www.bilgroup.co.uk

DWG NO. **NTW75TPRBJSWBST** REV **1**

NTW75TPRBJSWBST SHEET 1 OF 1