

| ITEM NO. | PRODUCT NUMBER | QTY |
|----------|-------------------|-----|
| 1 | BZPH200ASSWB | 1 |
| 2 | BZH200WNYBJM2060 | 1 |
| 3 | AXLE KIT | |
| | TH20X2X12 | 2 |
| | HEXBOLTM12X90Z8.8 | 1 |
| | NYLOCM12Z14MM | 1 |
| 4 | FGP/200/60/12 | 1 |

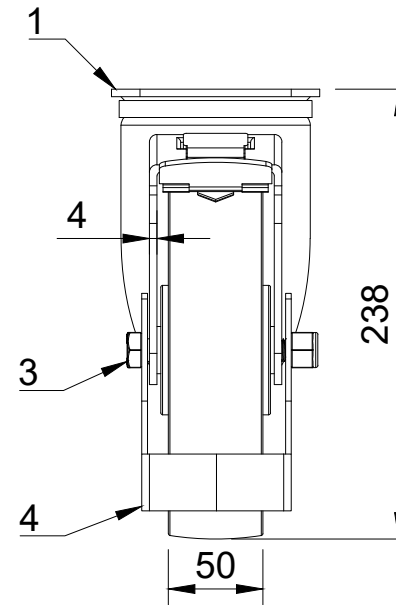
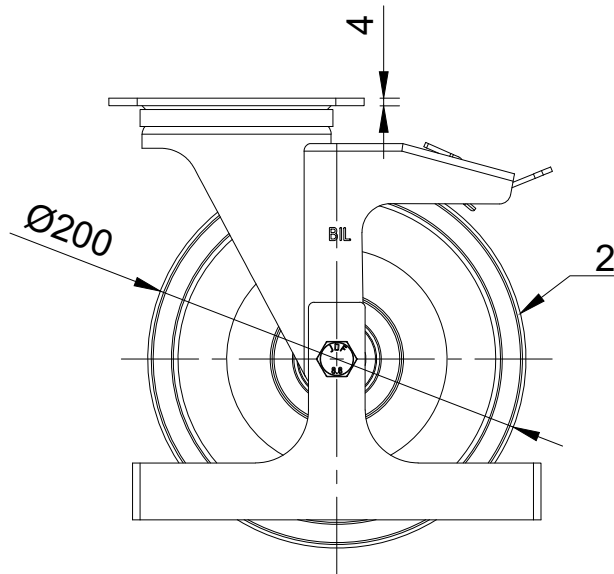

UNLESS OTHERWISE SPECIFIED DIMENSIONS ARE IN MILLIMETRES

Unspecified Tolerances
Machining ± 0.25mm
Fabrication ± 1mm

DRAWING DISCLAIMER

COPYRIGHT OF THIS DRAWING IS RESERVED BY BIL GROUP LTD. IT IS NOT REPRODUCED, COPIED, OR DISCLOSED TO A THIRD PARTY EITHER WHOLLY OR IN PART WITHOUT THE CONSENT IN WRITING OF BIL GROUP LTD

| | NAME | DATE |
|-------------|---------|----------|
| DRAWN BY | Matt | 10/10/23 |
| APPROVED BY | Kevin | 10/10/23 |
| SCALE | 1:4 | |
| WEIGHT | 3.625kg | |

BILGroup

BIL Group Ltd
Porte Marsh Road
Calne, Wiltshire, SN11 9BW
United Kingdom
Tel +44 (0)1249 822 222
www.bilgroup.co.uk

DWG NO. **BZPH200NYBJSWBFG** REV **1**

BZPH200NYBJSWBFG SHEET 1 OF 1