

ITEM NO.	PART NUMBER	QTY
1	BZPH100AS	1
2	BZXH100WPNRB	1
3	AXLE KIT	
	TUBEM15X50/CH	1
	HEXBOLTM10X70Z8.8	1
	NYLOCM10Z	1

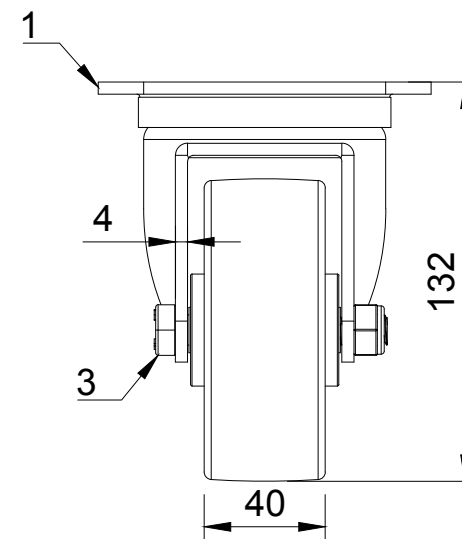

<p>UNLESS OTHERWISE SPECIFIED DIMENSIONS ARE IN MILLIMETRES</p> <p>Unspecified Tolerances Machining ± 0.25mm Fabrication ± 1mm</p>	<p>DRAWING DISCLAIMER</p> <p>COPYRIGHT OF THIS DRAWING IS RESERVED BY BIL GROUP LTD. IT IS NOT REPRODUCED, COPIED, OR DISCLOSED TO A THIRD PARTY EITHER WHOLLY OR IN PART WITHOUT THE CONSENT IN WRITING OF BIL GROUP LTD</p>		NAME	DATE	<p>BILGroup</p> <p>BIL Group Ltd Porte Marsh Road Calne, Wiltshire, SN11 9BW United Kingdom Tel +44 (0)1249 822 222 www.bilgroup.co.uk</p> <p>VARLEY</p> <p>H Varley Ltd Unit 5 Century Park Pacific Rd, Broadheath, Altrincham, Cheshire WA14 5BJ Tel +44 (0)161 928 9617 www.varley-castors.co.uk</p>
		DRAWN BY	Matt	12/06/25	
		APPROVED BY	Kevin	12/06/25	
		SCALE	2:5		
		WEIGHT	1.306kg		
<p>DWG NO. BZPH100XPNB</p>					REV 1
<p>BZPH100XPNB</p>					SHEET 1 OF 1