

ITEM NO.	PART NUMBER	QTY
1	BZMM150AS	1
2	BZXH160WPNBJM20	1
3	AXLE KIT	
	TH20X2X12	2
	HEXBOLTM12X80Z8.8	1
	NYLOCM12Z	1

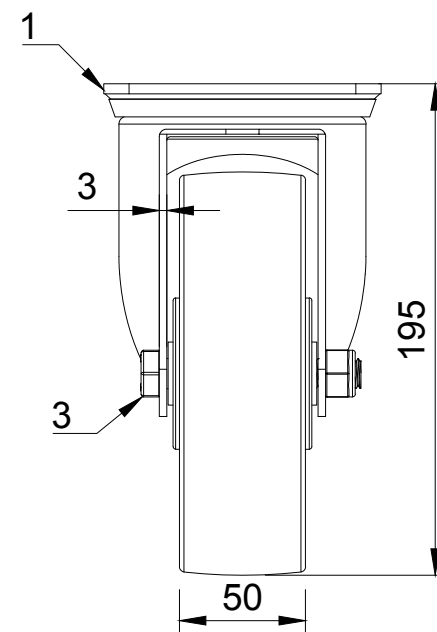

UNLESS OTHERWISE
SPECIFIED
DIMENSIONS ARE IN
MILLIMETRES

Unspecified Tolerances
Machining $\pm 0.25\text{mm}$
Fabrication $\pm 1\text{mm}$

DRAWING DISCLAIMER

COPYRIGHT OF THIS
DRAWING IS RESERVED BY
BIL GROUP LTD. IT IS NOT
REPRODUCED, COPIED, OR
DISCLOSED TO A THIRD
PARTY EITHER WHOLLY OR
IN PART WITHOUT THE
CONSENT IN WRITING OF
BIL GROUP LTD

	NAME	DATE
DRAWN BY	Matt	03/02/25
APPROVED BY	Kevin	03/02/25
SCALE	1:3	
WEIGHT	2.18kg	

BIL Group Ltd Porte Marsh Road Calne, Wiltshire, SN11 9BW United Kingdom Tel +44 (0)1249 822 222 www.bilgroup.co.uk		H Varley Ltd Unit 5 Century Park Pacific Rd, Broadheath, Altrincham, Cheshire WA14 5BJ Tel +44 (0)161 928 9617 www.varley-castors.co.uk	
			
DWG NO.		REV	
BZMM160XPNB		2	
BZMM160XPNB		SHEET 1 OF 1	