

ITEM NO.	PART NUMBER	QTY
1	BZMM100ASBH12SWB	1
2	BZH100WERBJM15	1
3	AXLE KIT	
	TUBEM15X40X10	1
	NYLONBUSH	1
	HEXBOLTM8X55Z8.8	1
	NYLOCM8Z	1

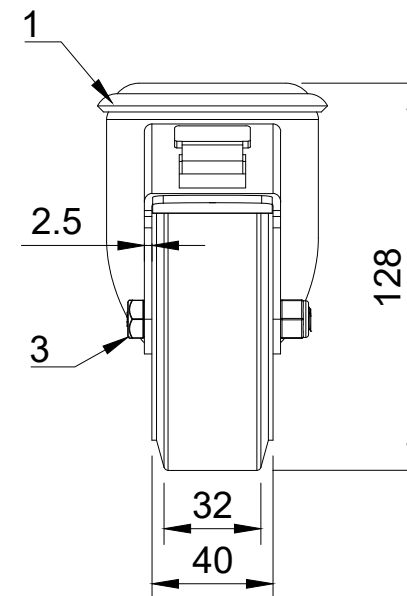

UNLESS OTHERWISE SPECIFIED DIMENSIONS ARE IN MILLIMETRES

Unspecified Tolerances  
Machining ± 0.25mm  
Fabrication ± 1mm

DRAWING DISCLAIMER

COPYRIGHT OF THIS DRAWING IS RESERVED BY BIL GROUP LTD. IT IS NOT REPRODUCED, COPIED, OR DISCLOSED TO A THIRD PARTY EITHER WHOLLY OR IN PART WITHOUT THE CONSENT IN WRITING OF BIL GROUP LTD

	NAME	DATE
DRAWN BY	Matt	13/02/24
APPROVED BY	Kevin	13/02/24
SCALE	2:5	
WEIGHT	1.087kg	

**BILGroup**

BIL Group Ltd  
Porte Marsh Road  
Calne, Wiltshire, SN11 9BW  
United Kingdom  
Tel +44 (0)1249 822 222  
www.bilgroup.co.uk

DWG NO. **BZMM100ERBJBH12SWB** REV **1**

**BZMM100ERBJBH12SWB** SHEET 1 OF 1