

ITEM NO.	PART NUMBER	QTY
1	BZKFL200AS	1
2	BZXH200WPTBJM20	1
3	AXLE KIT	
	TH20X2X12	2
	HEXBOLTM12X90Z8.8	1
	NYLOCM12Z14MM	1

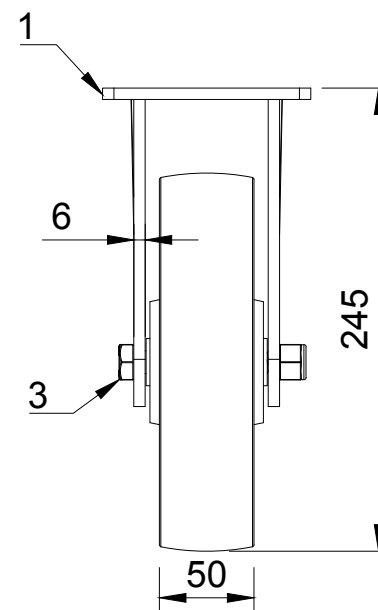

<p>UNLESS OTHERWISE SPECIFIED DIMENSIONS ARE IN MILLIMETRES</p> <p>Unspecified Tolerances Machining $\pm 0.25\text{mm}$ Fabrication $\pm 1\text{mm}$</p>	<p>DRAWING DISCLAIMER</p> <p>COPYRIGHT OF THIS DRAWING IS RESERVED BY BIL GROUP LTD. IT IS NOT REPRODUCED, COPIED, OR DISCLOSED TO A THIRD PARTY EITHER WHOLLY OR IN PART WITHOUT THE CONSENT IN WRITING OF BIL GROUP LTD</p>		NAME	DATE	<p>BILGroup</p> <p>BIL Group Ltd Porte Marsh Road Calne, Wiltshire, SN11 9BW United Kingdom Tel +44 (0)1249 822 222 www.bilgroup.co.uk</p>
		DRAWN BY	Matt	24/11/25	
		APPROVED BY	Kevin	24/11/25	
		SCALE	1:4		
		WEIGHT	5.329kg		
<p>DWG NO. BZKFL200PTBJ</p>					REV 1
<p>BZKFL200PTBJ</p>					SHEET 1 OF 1