

ITEM NO.	PART NUMBER	QTY
1	BZH80ASBH12SWB	1
2	BZMH80WNY	1
3	AXLE KIT	
	TUBEM12X46X10	1
	HEXBOLTM10X65Z8.8FULL	1
	NYLOCM10Z	1
4	BZPSTM16X30	1
	WM12X24X2Z	1
	WM12X50X1.5Z	1
	NYLOCM12Z	1

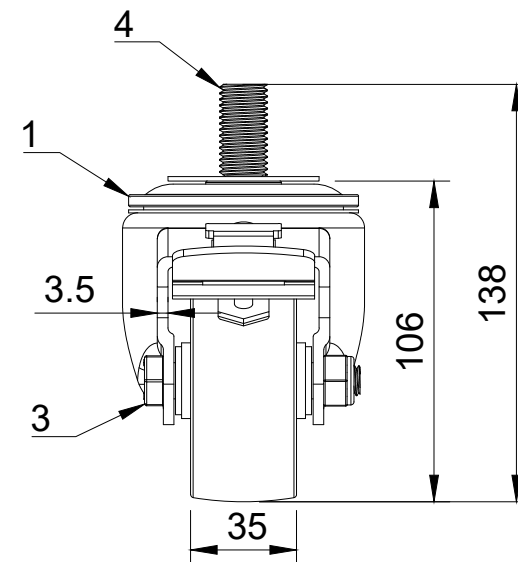

UNLESS OTHERWISE SPECIFIED DIMENSIONS ARE IN MILLIMETRES

Unspecified Tolerances  
Machining  $\pm 0.25\text{mm}$   
Fabrication  $\pm 1\text{mm}$

DRAWING DISCLAIMER

COPYRIGHT OF THIS DRAWING IS RESERVED BY BIL GROUP LTD. IT IS NOT REPRODUCED, COPIED, OR DISCLOSED TO A THIRD PARTY EITHER WHOLLY OR IN PART WITHOUT THE CONSENT IN WRITING OF BIL GROUP LTD

	NAME	DATE
DRAWN BY	Matt	07/05/24
APPROVED BY	Kevin	07/05/24
SCALE	2:5	
WEIGHT	1.05kg	



BIL Group Ltd  
 Porte Marsh Road  
 Calne, Wiltshire,  
 SN11 9BW  
 United Kingdom  
 Tel +44 (0)1249 822 222  
 www.bilgroup.co.uk

H Varley Ltd  
 Unit 5 Century Park  
 Pacific Rd, Broadheath,  
 Altrincham, Cheshire  
 WA14 5BJ  
 Tel +44 (0)161 928 9617  
 www.varley-castors.co.uk

DWG NO.	BZH80NYSWBM16X30	REV	1
BZH80NYSWBM16X30		SHEET 1 OF 1	