

ITEM NO.	PART NUMBER	QTY
1	BZH125ASSWB	1
2	BZH125WPTBJM20	1
3	AXLE KIT	
	TH20X1X10	2
	HEXBOLTM10X70Z8.8	1
	NYLOCM10Z	1

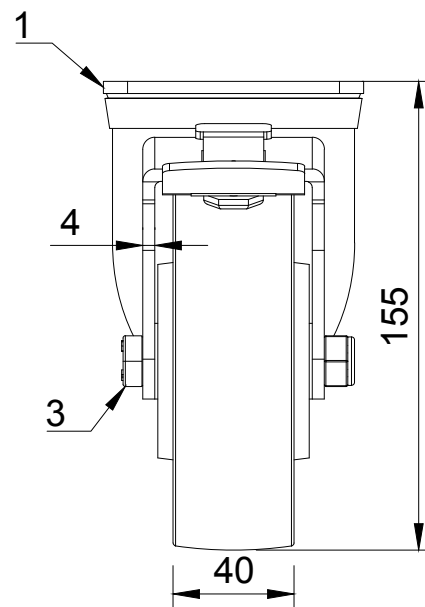

<p>UNLESS OTHERWISE SPECIFIED DIMENSIONS ARE IN MILLIMETRES</p> <p>Unspecified Tolerances Machining <math>\pm 0.25\text{mm}</math> Fabrication <math>\pm 1\text{mm}</math></p>	<p>DRAWING DISCLAIMER</p> <p>COPYRIGHT OF THIS DRAWING IS RESERVED BY BIL GROUP LTD. IT IS NOT REPRODUCED, COPIED, OR DISCLOSED TO A THIRD PARTY EITHER WHOLLY OR IN PART WITHOUT THE CONSENT IN WRITING OF BIL GROUP LTD</p>		NAME	DATE	<p><b>BILGroup</b></p> <p>BIL Group Ltd Porte Marsh Road Calne, Wiltshire, SN11 9BW United Kingdom Tel +44 (0)1249 822 222 www.bilgroup.co.uk</p> <p><b>VARLEY</b></p> <p>H Varley Ltd Unit 5 Century Park Pacific Rd, Broadheath, Altrincham, Cheshire WA14 5BJ Tel +44 (0)161 928 9617 www.varley-castors.co.uk</p>
		DRAWN BY	Matt	12/06/25	
		APPROVED BY	Kevin	12/06/25	
		SCALE	2:5		
		WEIGHT	3.032kg		
<p>DWG NO. <b>BZH125PTBJSWB</b></p>					REV <b>1</b>
<p><b>BZH125PTBJSWB</b></p>					SHEET 1 OF 1