

ITEM NO.	PART NUMBER	QTY
1	BZH100ASSWB	1
2	BZXH100WPNRB	1
3	AXLE KIT	
	TUBEM15X52/CH	1
	HEXBOLTM10X70Z8.8	1
	NYLOCM10Z	1

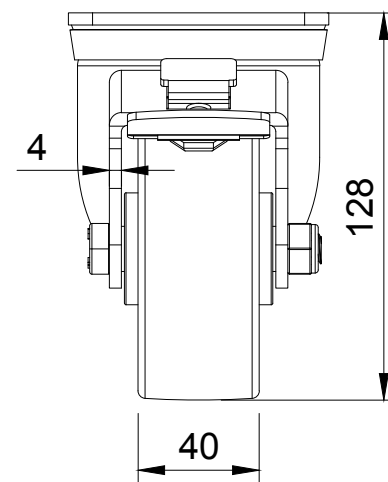

UNLESS OTHERWISE
SPECIFIED
DIMENSIONS ARE IN
MILLIMETRES

Unspecified Tolerances
Machining $\pm 0.25\text{mm}$
Fabrication $\pm 1\text{mm}$

DRAWING DISCLAIMER

COPYRIGHT OF THIS
DRAWING IS RESERVED BY
BIL GROUP LTD. IT IS NOT
REPRODUCED, COPIED, OR
DISCLOSED TO A THIRD
PARTY EITHER WHOLLY OR
IN PART WITHOUT THE
CONSENT IN WRITING OF
BIL GROUP LTD

	NAME	DATE
DRAWN BY	Matt	10/06/25
APPROVED BY	Kevin	10/06/25
SCALE	2:5	
WEIGHT	1.327kg	

<p>BIL Group Ltd Porte Marsh Road Calne, Wiltshire, SN11 9BW United Kingdom Tel +44 (0)1249 822 222 www.bilgroup.co.uk</p>		<p>H Varley Ltd Unit 5 Century Park Pacific Rd, Broadheath, Altrincham, Cheshire WA14 5BJ Tel +44 (0)161 928 9617 www.varley-castors.co.uk</p>	
<p>BILGroup</p>		<p>VARLEY</p>	
DWG NO.		REV	
BZH100XPNB SWB		1	
BZH100XPNB SWB		SHEET 1 OF 1	