

| ITEM NO. | PART NUMBER | QTY |
|----------|------------------|-----|
| 1 | JAZXHRH | 1 |
| 2 | BZK150PTBJSWB/WT | 1 |
| 3 | FIXINGS | |
| | WM10X21X2 | 8 |
| | BOLTM10X30 | 4 |
| | NYLOCM10Z | 4 |

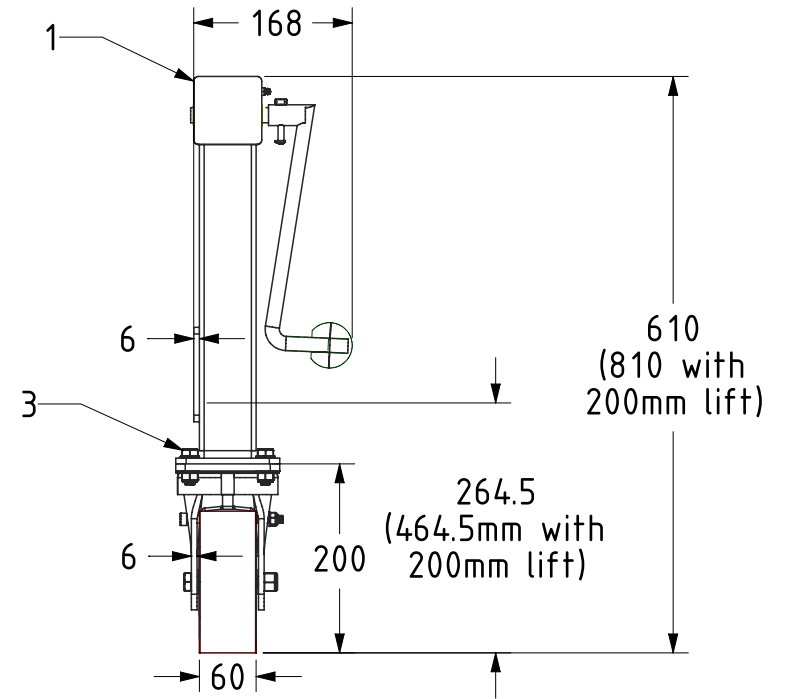

| | | | | | |
|--|---|-------------|----------|----------|---|
| <p>UNLESS OTHERWISE SPECIFIED DIMENSIONS ARE IN MILLIMETRES</p> <p>Unspecified Tolerances Machining ± 0.25mm Fabrication ± 1mm</p> | <p>DRAWING DISCLAIMER</p> <p>COPYRIGHT OF THIS DRAWING IS RESERVED BY BIL GROUP LTD. IT IS ISSUED ON CONDITION THAT IT IS NOT REPRODUCED, COPIED, OR DISCLOSED TO A THIRD PARTY EITHER WHOLLY OR IN PART WITHOUT THE CONSENT IN WRITING OF BIL GROUP LTD.</p> | | NAME | DATE | <p>BIL Group Ltd, Porte Marsh Road, Calne, Wiltshire, SN11 9BW, United Kingdom Tel +44 (0)1249 822 222 www.bilgroup.co.uk</p> |
| | | DRAWN | Matt | 18/01/23 | |
| | | APPROVED BY | Kevin | 18/01/23 | |
| | | SCALE | 1:8 | | |
| | | WEIGHT | 14.388kg | | |
| <p>DWG NO. JAZHSK150PTBJSWBWTRH</p> | | | | | REV 1 |
| <p>JAZHSK150PTBJSWB/WT/RH SHEET 1 OF 1</p> | | | | | |