

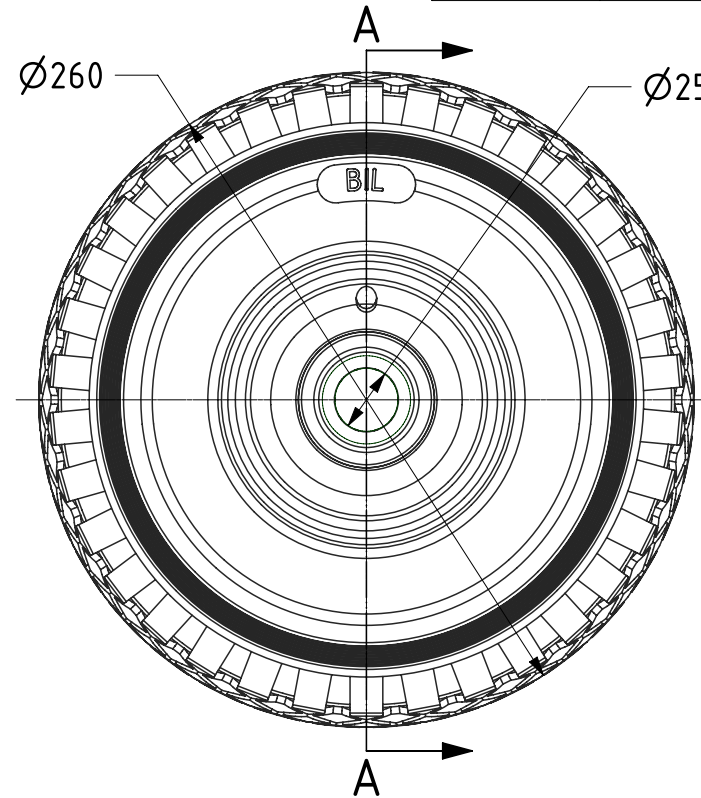

| ITEM NO. | PART NUMBER | QTY |
|----------|---------------------|-----|
| 1 | TYRE260PUD | 1 |
| 2 | RIM300X4STGREY35X61 | 1 |
| 3 | RBM25X35X45 | 1 |
| 4 | HUBRETAINER254 | 2 |

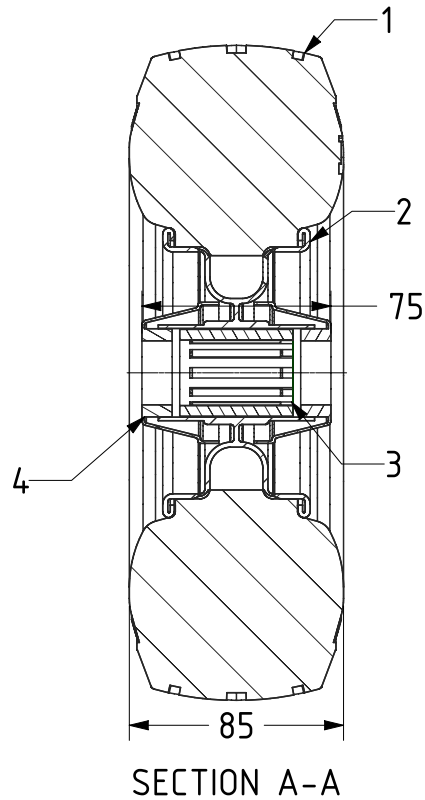

UNLESS OTHERWISE SPECIFIED DIMENSIONS ARE IN MILLIMETRES

Unspecified Tolerances
Machining $\pm 0.25\text{mm}$
Fabrication $\pm 1\text{mm}$

DRAWING DISCLAIMER

COPYRIGHT OF THIS DRAWING IS RESERVED BY BIL GROUP LTD. IT IS ISSUED ON CONDITION THAT IT IS NOT REPRODUCED, COPIED, OR DISCLOSED TO A THIRD PARTY EITHER WHOLLY OR IN PART WITHOUT THE CONSENT IN WRITING OF BIL GROUP LTD.

| | NAME | DATE |
|-------------|---------|----------|
| DRAWN | Matt | 10/10/22 |
| APPROVED BY | Kevin | 10/10/22 |
| SCALE | 1:3 | |
| WEIGHT | 2.024kg | |

| | | |
|---|---|--------------|
|  | BIL Group Ltd, Porte Marsh Road, Calne Wiltshire, SN11 9BW, United Kingdom Tel +44 (0)1249 822 222 Fax: +44 (0)1249 822 300 www.bilgroup.co.uk | |
| | DWG NO. BZWMPUR26025D | REV 1 |
| BZWMPUR26025D | | SHEET 1 OF 1 |