

ITEM NO.	PART NUMBER	QTY
1	BZHF100AS	1
2	BZH100WNPRB61	1
3	AXLE KIT	
	TUBEM15X50/CH	1
	HEXBOL TM10X65Z8.8FULL	1
	NYLOCM10Z	1

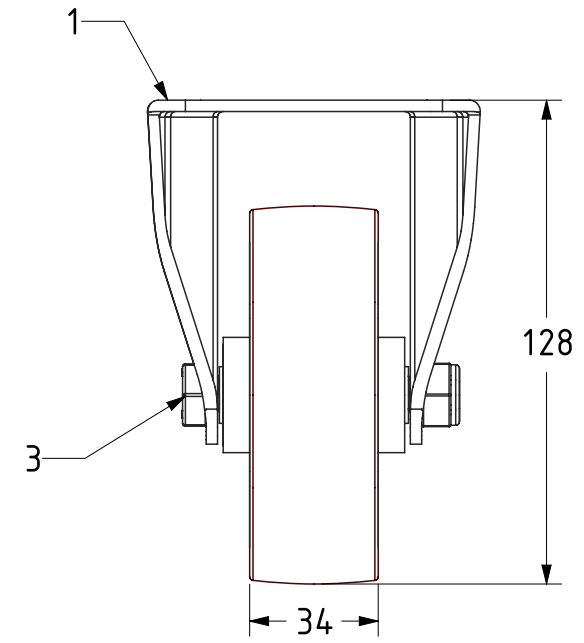

UNLESS OTHERWISE SPECIFIED DIMENSIONS ARE IN MILLIMETRES

Unspecified Tolerances
Machining ± 0.25mm
Fabrication ± 1mm

DRAWING DISCLAIMER

COPYRIGHT OF THIS DRAWING IS RESERVED BY BIL GROUP LTD. IT IS ISSUED ON CONDITION THAT IT IS NOT REPRODUCED, COPIED, OR DISCLOSED TO A THIRD PARTY EITHER WHOLLY OR IN PART WITHOUT THE CONSENT IN WRITING OF BIL GROUP LTD.

	NAME	DATE
DRAWN	Matt	14/03/22
APPROVED BY	Kevin	14/03/22
SCALE	1:2	
WEIGHT	0.699kg	

BIL Group Ltd, Porte Marsh Road, Calne
Wiltshire, SN11 9BW, United Kingdom
Tel +44 (0)1249 822 222 Fax: +44 (0)1249 822 300
www.bilgroup.co.uk

DWG NO. BZEHF100NPB	REV 1
BZEHF100NPB	SHEET 1 OF 1