

| ITEM NO. | PART NUMBER       | QTY |
|----------|-------------------|-----|
| 1        | BZH125WCVBJM20    | 1   |
| 2        | BEARING6005X1     | 2   |
| 3        | BSM25XM35         | 1   |
| 4        | BEARINGSPACER47X2 | 2   |

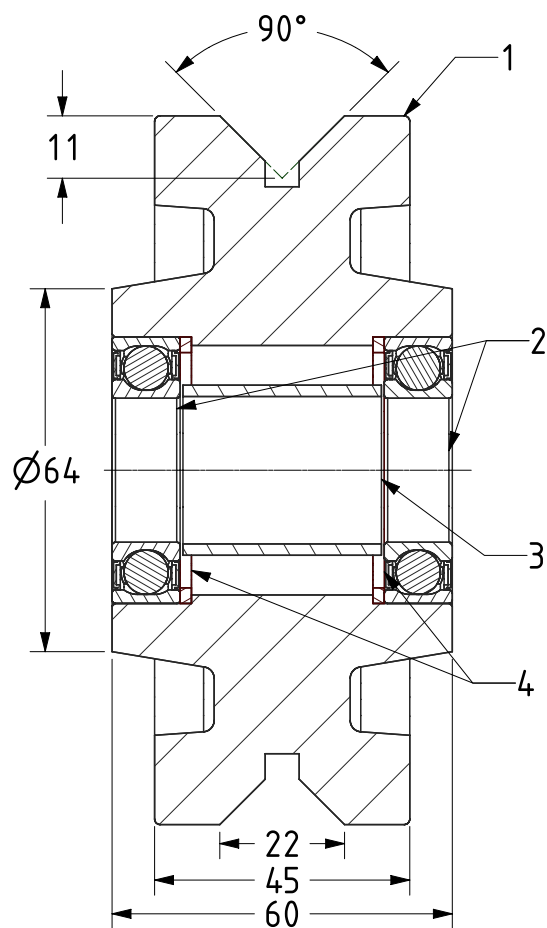

SECTION A-A

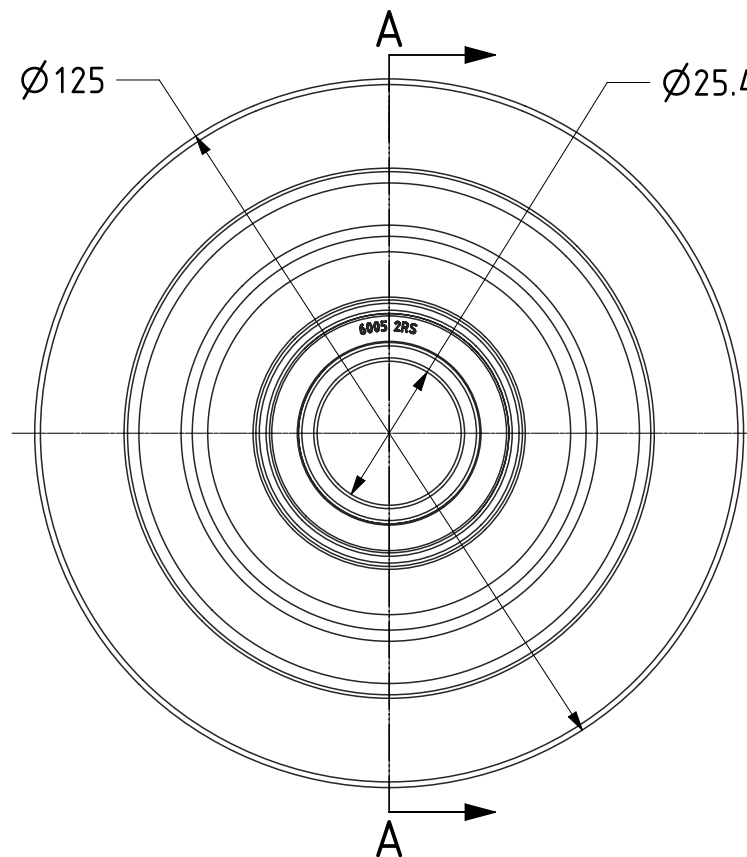

UNLESS OTHERWISE SPECIFIED DIMENSIONS ARE IN MILLIMETRES

Unspecified Tolerances  
Machining ± 0.25mm  
Fabrication ± 1mm

DRAWING DISCLAIMER

COPYRIGHT OF THIS DRAWING IS RESERVED BY BIL GROUP LTD. IT IS ISSUED ON CONDITION THAT IT IS NOT REPRODUCED, COPIED, OR DISCLOSED TO A THIRD PARTY EITHER WHOLLY OR IN PART WITHOUT THE CONSENT IN WRITING OF BIL GROUP LTD.

|             | NAME    | DATE     |
|-------------|---------|----------|
| DRAWN       | Matt    | 18/05/22 |
| APPROVED BY | Kevin   | 18/05/22 |
| SCALE       | 3:4     |          |
| WEIGHT      | 3.006kg |          |

|   |   |       |
|---|---|-------|
|  | BIL Group Ltd, Porte Marsh Road, Calne<br>Wiltshire, SN11 9BW, United Kingdom<br>Tel +44 (0)1249 822 222 Fax: +44 (0)1249 822 300<br>www.bilgroup.co.uk |       |
|   | DWG NO. BZH125WCVBJM254   | REV 1 |
| BZH125WCVBJM254 SHEET 1 OF 1  |   |       |