

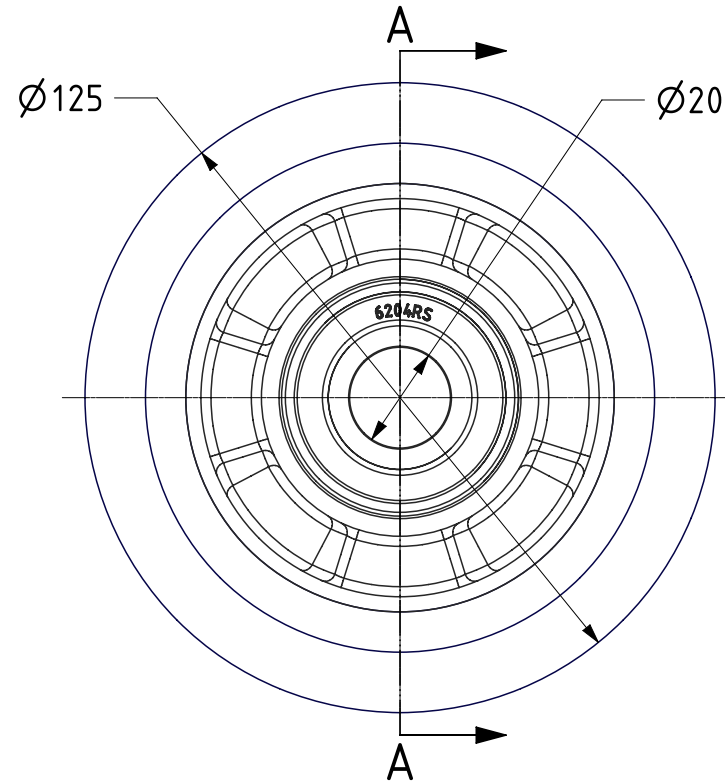

ITEM NO.	PART NUMBER	QTY
1	75 SHORE A ERGONOMIC POLYURETHANE TYRE	1
2	ALUMINIUM RIM	1
3	BEARING6204	2
4	BEARING SPACER	1

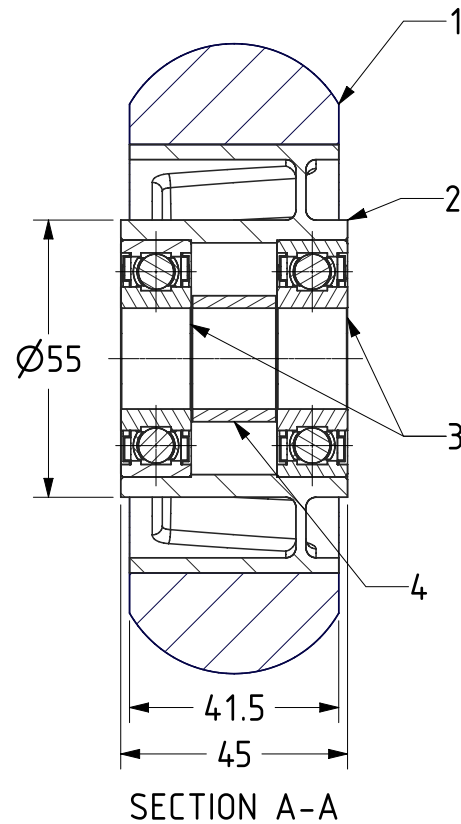

UNLESS OTHERWISE SPECIFIED DIMENSIONS ARE IN MILLIMETRES

Unspecified Tolerances
Machining ± 0.25mm
Fabrication ± 1mm

DRAWING DISCLAIMER

COPYRIGHT OF THIS DRAWING IS RESERVED BY BIL GROUP LTD. IT IS ISSUED ON CONDITION THAT IT IS NOT REPRODUCED, COPIED, OR DISCLOSED TO A THIRD PARTY EITHER WHOLLY OR IN PART WITHOUT THE CONSENT IN WRITING OF BIL GROUP LTD.

	NAME	DATE
DRAWN	Matt	24/02/22
APPROVED BY	Kevin	24/02/22
SCALE	2:3	
WEIGHT	0.700kg	

 BIL Group Ltd, Porte Marsh Road, Calne Wiltshire, SN11 9BW, United Kingdom Tel +44 (0)1249 822 222 Fax: +44 (0)1249 822 300 www.bilgroup.co.uk	DWG NO.	REV
	BZMH125WRSPABJM20	1
BZMH125WRSPABJM20 SHEET 1 OF 1		