

**DRAWING DISCLAIMER**  
 COPYRIGHT OF THIS DRAWING IS RESERVED BY BIL GROUP LTD. IT IS ISSUED ON CONDITION THAT IT IS NOT REPRODUCED, COPIED, OR DISCLOSED TO A THIRD PARTY EITHER WHOLLY OR IN PART WITHOUT THE CONSENT IN WRITING OF BIL GROUP LTD.

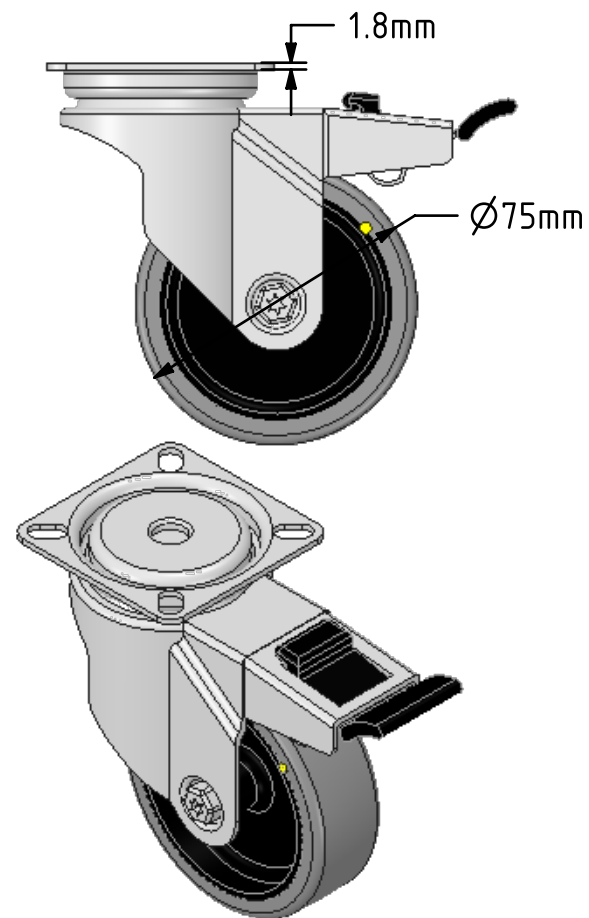

**Description:**  
 SSRA75GRECSWB

Grade 304 Pressed stainless steel swivel castor with a flate plate fitted with a grey electrically conductive rubber tyre on polypropylene centred wheel with a plain bearing and a total lock brake. Wheel diameter 75mm, tread width 24mm, overall height 101mm. plate size 60mm x 60mm, hole centres 49.5mm x 49.5mm or 42.5mm x 42.5mm Load capacity 75kg. Conductive offers a resistance R<10KΩ

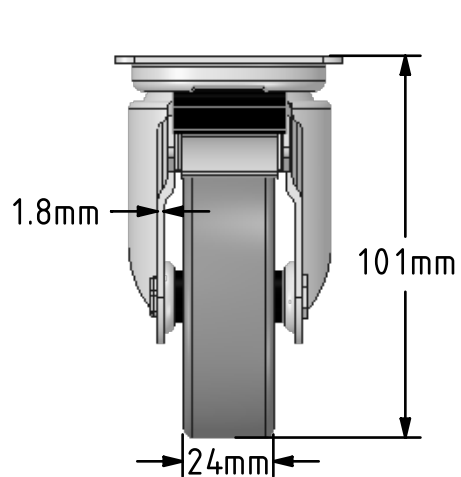
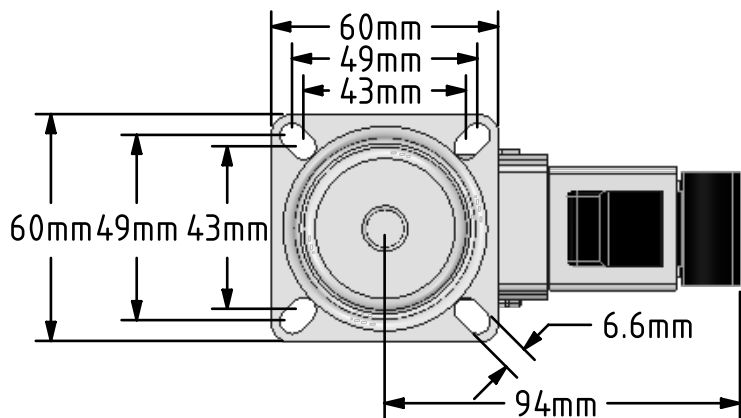

	NAME	DATE
DRAWN	Matt	19/04/17
APPROVED BY	Tim W	19/04/17
SCALE	1:2	19/04/17
WEIGHT	0.326kg	19/04/17

UNLESS OTHERWISE SPECIFIED DIMENSIONS ARE IN MILLIMETRES

Unspecified Tolerances  
 Machining ± 0.25mm  
 Fabrication ± 1mm



BIL Group Ltd, Porte Marsh Road, Calne  
 Wiltshire, SN11 9BW, United Kingdom  
 Tel +44 (0)1249 822 222 Fax: +44 (0)1249 822 300  
 www.bilgroup.co.uk

TITLE

SSRA75GRECSWB

SIZE	DWG NO.	REV
A4	BILCW03SSRA75GRECSWB_01	1

FILE NAME BILCW03SSRA75GRECSWB\_01.PDF SHEET 1 OF 1