

DRAWING DISCLAIMER
 COPYRIGHT OF THIS DRAWING IS RESERVED BY BIL GROUP LTD. IT IS ISSUED ON CONDITION THAT IT IS NOT REPRODUCED, COPIED, OR DISCLOSED TO A THIRD PARTY EITHER WHOLLY OR IN PART WITHOUT THE CONSENT IN WRITING OF BIL GROUP LTD.

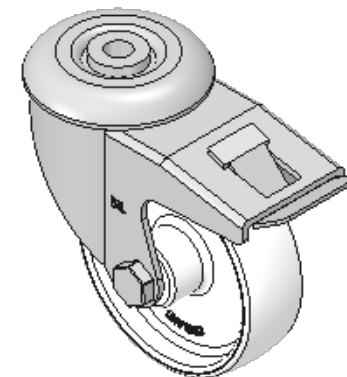

Description:
 SSEH100NYBH12SWB

Grade 304 Pressed stainless steel swivel castor with a 12mm bolt hole fitted with a white nylon wheel with a plain bearing and a total lock brake. Wheel diameter 100mm, tread width 32mm, overall height 128mm, Load capacity 270kg

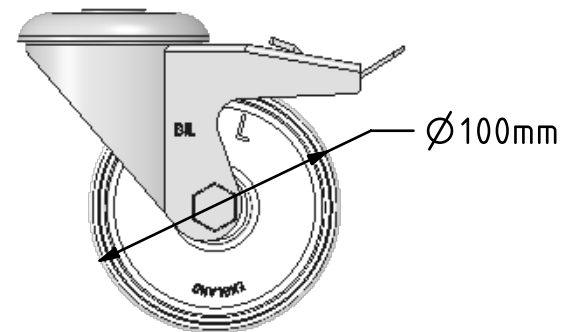
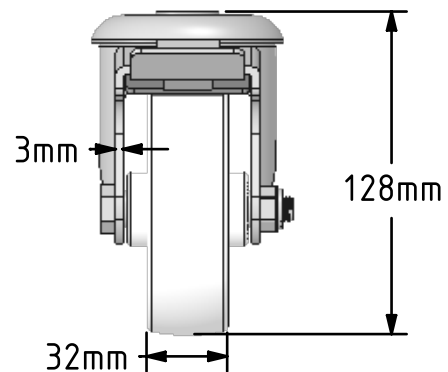
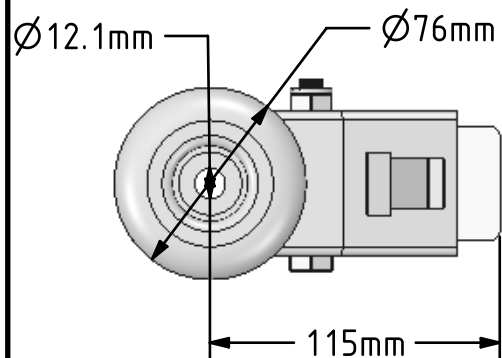

	NAME	DATE
DRAWN	Matt	19/06/17
APPROVED BY	Chris	19/06/17
SCALE	1:3	19/06/17
WEIGHT	0.92kg	19/06/17

UNLESS OTHERWISE SPECIFIED DIMENSIONS ARE IN MILLIMETRES
 Unspecified Tolerances
 Machining ± 0.25mm
 Fabrication ± 1mm

 BIL Group Ltd, Porte Marsh Road, Calne Wiltshire, SN11 9BW, United Kingdom
 Tel +44 (0)1249 822 222 Fax: +44 (0)1249 822 300
 www.bilgroup.co.uk

TITLE
 SSEH100NYBH12SWB

SIZE	DWG NO.	REV
A4	BILCW03SSEH100NYBH12SWB_02	2

FILE NAME BILCW03SSEH100NYBH12SWB_02.PDF SHEET 1 OF 1