

DRAWING DISCLAIMER
 COPYRIGHT OF THIS DRAWING IS RESERVED BY BIL GROUP LTD. IT IS ISSUED ON CONDITION THAT IT IS NOT REPRODUCED, COPIED, OR DISCLOSED TO A THIRD PARTY EITHER WHOLLY OR IN PART WITHOUT THE CONSENT IN WRITING OF BIL GROUP LTD.

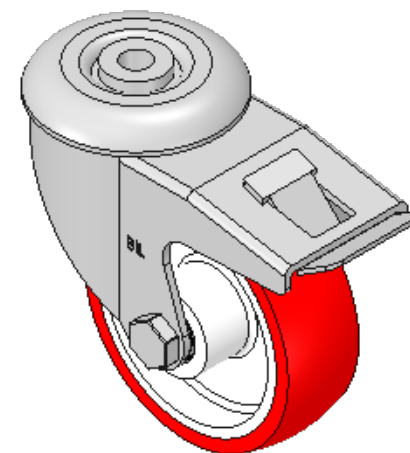

Description:
 SSEH100NPBBH12SWB

Grade 304 Pressed stainless steel swivel castor with a ± 12 mm bolt hole fitted with a red polyurethane tyred white nylon centred wheel with a roller bearing and a total lock brake. Wheel diameter 100mm, tread width 33mm, overall height 130mm, Load capacity 250kg

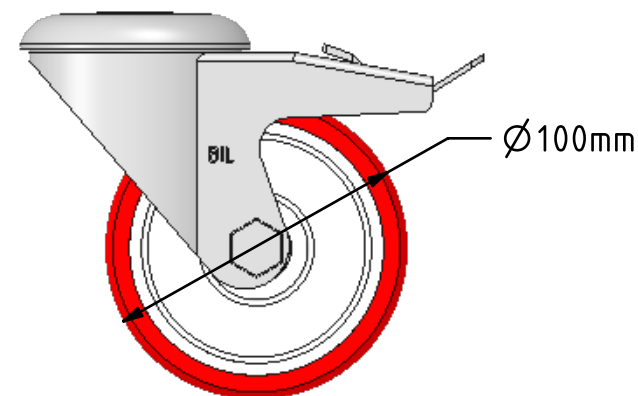
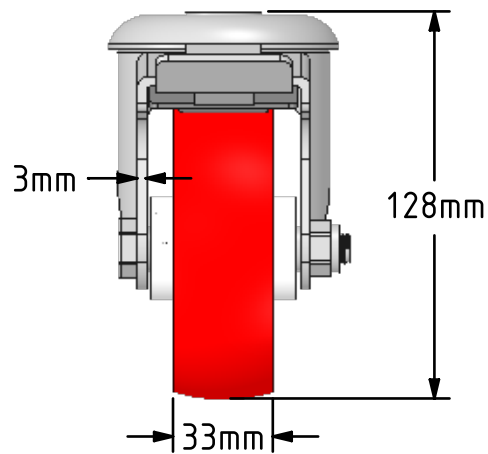
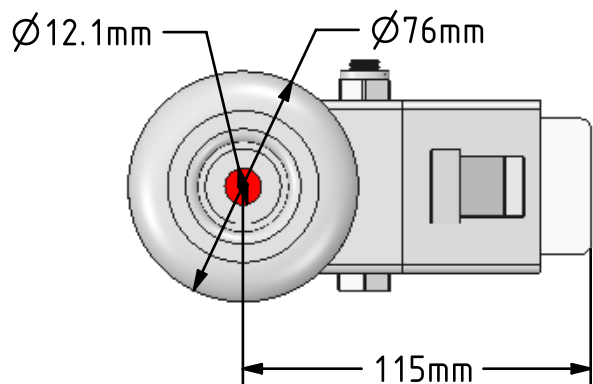

	NAME	DATE
DRAWN	Matt	19/05/17
APPROVED BY	Chris	19/05/17
SCALE	2:5	19/05/17
WEIGHT	1.012kg	19/05/17



BIL Group Ltd, Porte Marsh Road, Calne
 Wiltshire, SN11 9BW, United Kingdom
 Tel +44 (0)1249 822 222 Fax: +44 (0)1249 822 300
 www.bilgroup.co.uk

TITLE

SSEH100NPBBH12SWB

UNLESS OTHERWISE SPECIFIED DIMENSIONS ARE IN MILLIMETRES

Unspecified Tolerances
 Machining ± 0.25 mm
 Fabrication ± 1 mm

SIZE	DWG NO.	REV
A4	BILCW03SSEH100NPBBH12SWB__01	1

FILE NAME BILCW03SSEH100NPBBH12SWB__01.PDF SHEET 1 OF 1