

DRAWING DISCLAIMER
 COPYRIGHT OF THIS DRAWING IS RESERVED BY BIL GROUP LTD. IT IS ISSUED ON CONDITION THAT IT IS NOT REPRODUCED, COPIED, OR DISCLOSED TO A THIRD PARTY EITHER WHOLLY OR IN PART WITHOUT THE CONSENT IN WRITING OF BIL GROUP LTD.

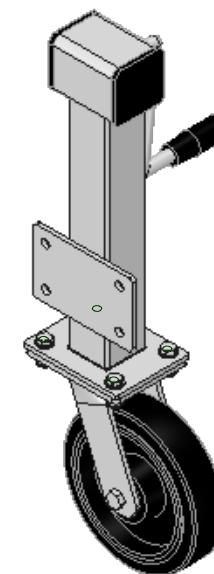

Description:
 JAZHS200CRBJ

Side winding jacking unit fitted with a fabricated swivel castor with a 200mm black elastic rubber tyred cast iron centred wheel with ball bearings wheel to carry a maximum load capacity of 450kg per complete unit. Please note Jacking castors are rated on a different principle to other castors. They lift the load off the floor and therefore each castor is liable to carry half the total load, also please note the maximum lift is 200mm but when jacked up to the height please beware of any obstacles as a sudden shock could result in the inner square tube bend around the outer tube.

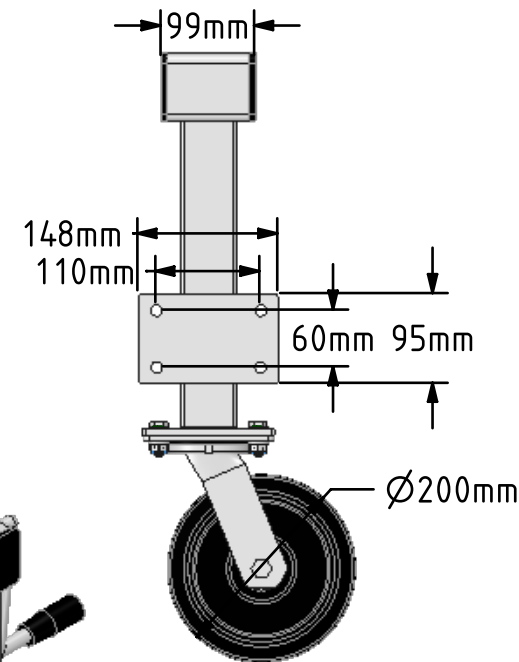
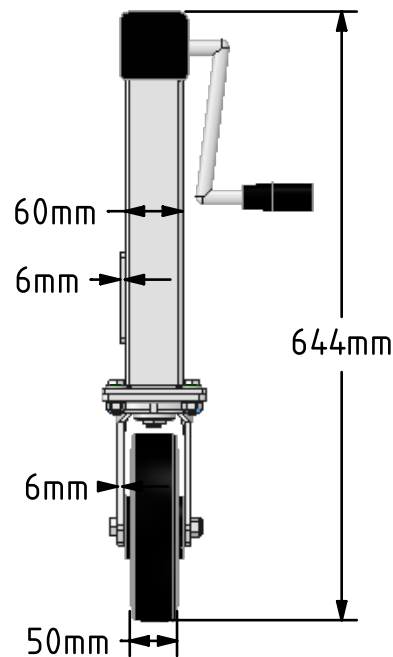
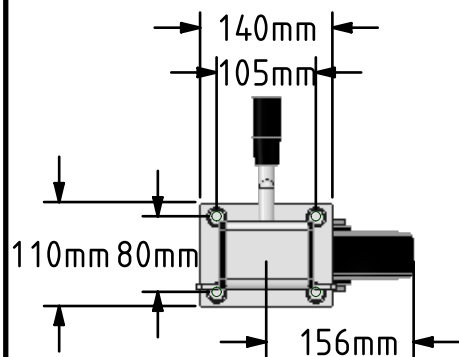

	NAME	DATE
DRAWN	Matt	28/11/17
APPROVED BY	Chris	28/11/17
SCALE	1:8	28/11/17
WEIGHT	13.729kg	28/11/17

UNLESS OTHERWISE SPECIFIED DIMENSIONS ARE IN MILLIMETRES

Unspecified Tolerances
 Machining ± 0.25mm
 Fabrication ± 1mm



BIL Group Ltd, Porte Marsh Road, Calne
 Wiltshire, SN11 9BW, United Kingdom
 Tel +44 (0)1249 822 222 Fax: +44 (0)1249 822 300
 www.bilgroup.co.uk

TITLE

JAZHS200CRBJ

SIZE DWG NO.
 A4

BILCW03JAZHS200CRBJ__01

REV
 1

FILE NAME BILCW03JAZHS200CRBJ__01.PDF SHEET 1 OF 1