

DRAWING DISCLAIMER  
 COPYRIGHT OF THIS DRAWING IS RESERVED BY BIL GROUP LTD. IT IS ISSUED ON CONDITION THAT IT IS NOT REPRODUCED, COPIED, OR DISCLOSED TO A THIRD PARTY EITHER WHOLLY OR IN PART WITHOUT THE CONSENT IN WRITING OF BIL GROUP LTD.

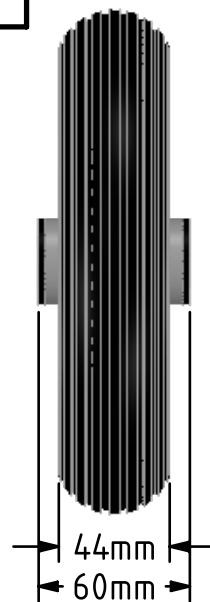

Description:  
 BZWPMR200202R

Black pneumatic tyre on grey steel centre rim with a roller bearing. Fitted with a 2 ply ribbed tread patterned tyre. Wheel diameter 200mm, tread width 50mm, hub 60mm, bore 20mm. Load capacity 75kg at 4KPH, \*\*Max PSI 36 \*\*

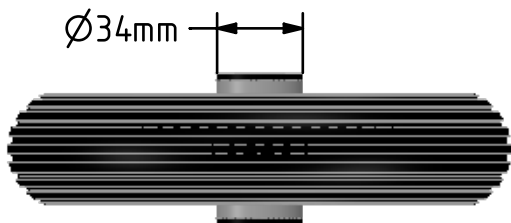
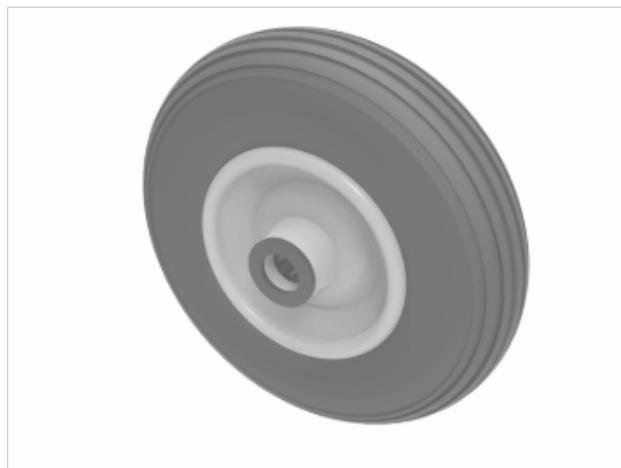

|             | NAME    | DATE     |
|-------------|---------|----------|
| DRAWN       | Matt    | 06/11/18 |
| APPROVED BY | Chris   | 06/11/18 |
| SCALE       | 1:3     | 06/11/18 |
| WEIGHT      | 0.836kg | 06/11/18 |



BIL Group Ltd, Porte Marsh Road, Calne  
 Wiltshire, SN11 9BW, United Kingdom  
 Tel +44 (0)1249 822 222 Fax: +44 (0)1249 822 300  
 www.bilgroup.co.uk

TITLE

BZWPMR200202R

UNLESS OTHERWISE SPECIFIED DIMENSIONS ARE IN MILLIMETRES

Unspecified Tolerances  
 Machining ± 0.25mm  
 Fabrication ± 1mm

| SIZE | DWG NO.                 | REV |
|------|-------------------------|-----|
| A4   | BILCW01BZWPMR200202R_01 | 1   |

FILE NAME BILCW01BZWPMR200202R\_01.PDF SHEET 1 OF 1