

DRAWING DISCLAIMER
 COPYRIGHT OF THIS DRAWING IS RESERVED BY BIL GROUP LTD. IT IS ISSUED ON CONDITION THAT IT IS NOT REPRODUCED, COPIED, OR DISCLOSED TO A THIRD PARTY EITHER WHOLLY OR IN PART WITHOUT THE CONSENT IN WRITING OF BIL GROUP LTD.

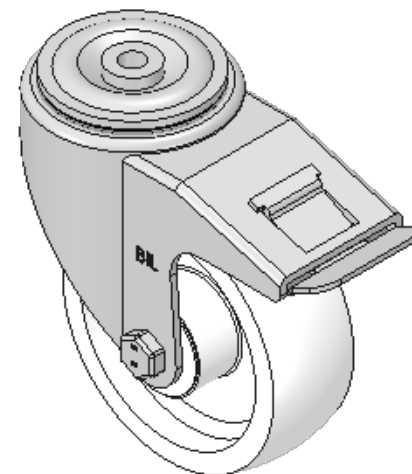

Description:
 BZWH125NYBH12SWB

Pressed steel swivel castor with a 12 mm bolt hole fitted with a white nylon wheel with plain bearing and total lock brake. Wheel diameter 125mm, tread width 45mm, overall height 165mm, Load capacity 400kg.

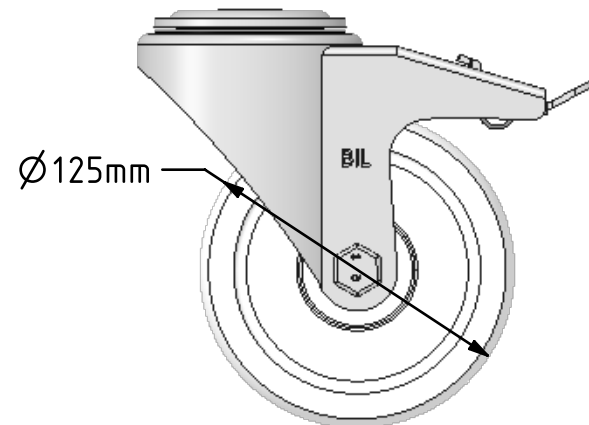
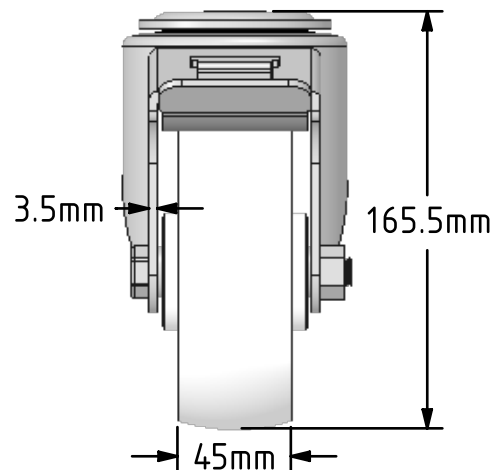
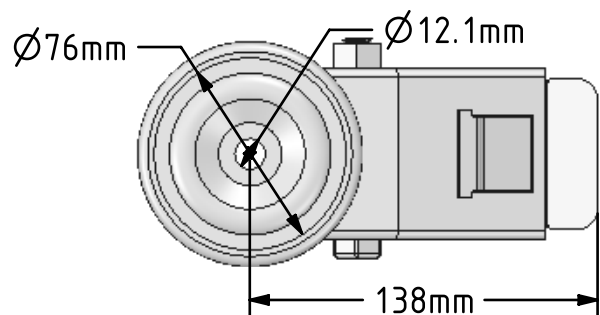

	NAME	DATE
DRAWN	Matt	15/02/18
APPROVED BY	Tim W	15/02/18
SCALE	1:3	15/02/18
WEIGHT	1.589kg	15/02/18

 BIL Group Ltd, Porte Marsh Road, Calne
 Wiltshire, SN11 9BW, United Kingdom
 Tel +44 (0)1249 822 222 Fax: +44 (0)1249 822 300
 www.bilgroup.co.uk

TITLE
 BZWH125NYBH12SWB

UNLESS OTHERWISE SPECIFIED DIMENSIONS ARE IN MILLIMETRES
 Unspecified Tolerances
 Machining ± 0.25mm
 Fabrication ± 1mm

SIZE	DWG NO.	REV
A4	BILCW03BZWH125NYBH12SWB_01	1

FILE NAME BILCW03BZWH125NYBH12SWB_01.PDF SHEET 1 OF 1