

DRAWING DISCLAIMER
 COPYRIGHT OF THIS DRAWING IS RESERVED BY BIL GROUP LTD. IT IS ISSUED ON CONDITION THAT IT IS NOT REPRODUCED, COPIED, OR DISCLOSED TO A THIRD PARTY EITHER WHOLLY OR IN PART WITHOUT THE CONSENT IN WRITING OF BIL GROUP LTD.

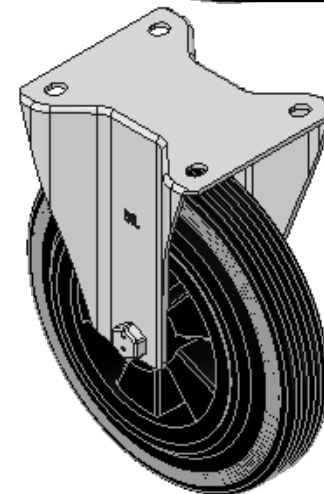

Description:
 BZWBF200PSB

Pressed steel fixed castor with a top plate fixing fitted with a black rubber tyred polypropylene centred wheel with a roller bearing. Wheel diameter 200mm, tread width 50mm, overall height 238mm, top plate 133mm x 115mm, hole centres 105mm x 80/75mm. Load capacity 205kg.

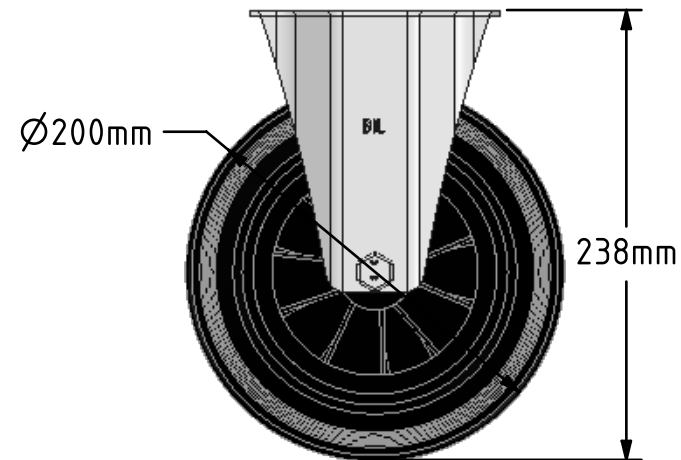
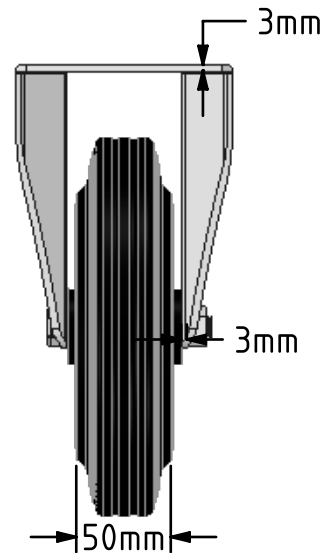
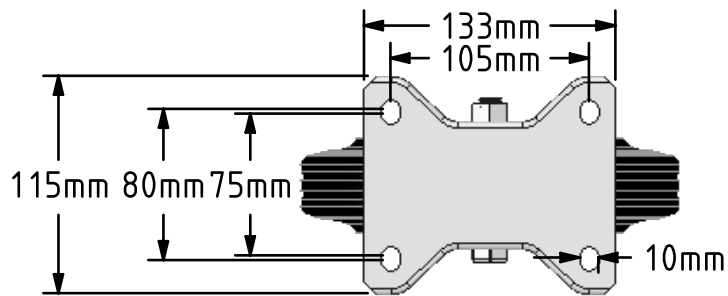

	NAME	DATE
DRAWN	Matt	23/01/18
APPROVED BY	Tim W	23/01/18
SCALE	1:4	23/01/18
WEIGHT	2.33kg	23/01/18

 BIL Group Ltd, Porte Marsh Road, Calne
 Wiltshire, SN11 9BW, United Kingdom
 Tel +44 (0)1249 822 222 Fax: +44 (0)1249 822 300
 www.bilgroup.co.uk

TITLE	BZWBF200PSB	
-------	-------------	--

UNLESS OTHERWISE SPECIFIED DIMENSIONS ARE IN MILLIMETRES
 Unspecified Tolerances
 Machining ± 0.25mm
 Fabrication ± 1mm

SIZE	DWG NO.	REV
A4	BILCW03BZWBF200PSB_01	1
FILE NAME	BILCW03BZWBF200PSB_01.PDF SHEET 1 OF 1	