

DRAWING DISCLAIMER  
 COPYRIGHT OF THIS DRAWING IS RESERVED BY BIL GROUP LTD. IT IS ISSUED ON CONDITION THAT IT IS NOT REPRODUCED, COPIED, OR DISCLOSED TO A THIRD PARTY EITHER WHOLLY OR IN PART WITHOUT THE CONSENT IN WRITING OF BIL GROUP LTD.

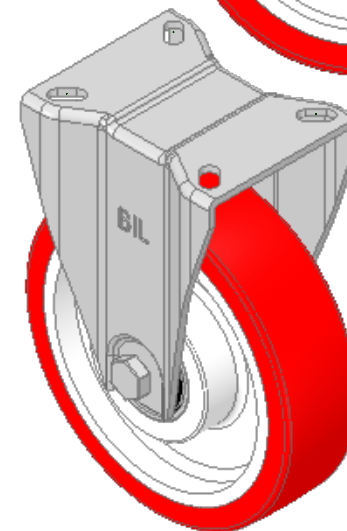

Description:  
 BZPHFL150NPBJ

Pressed steel fixed castor with a top plate fixing fitted with a red polyurethane tyre white nylon centred wheel with ball bearings. Wheel diameter 150mm, tread width 40mm, overall height 190mm, top plate 105mm x 85mm, hole centres 80mm x 60mm. Load capacity 400Kg.

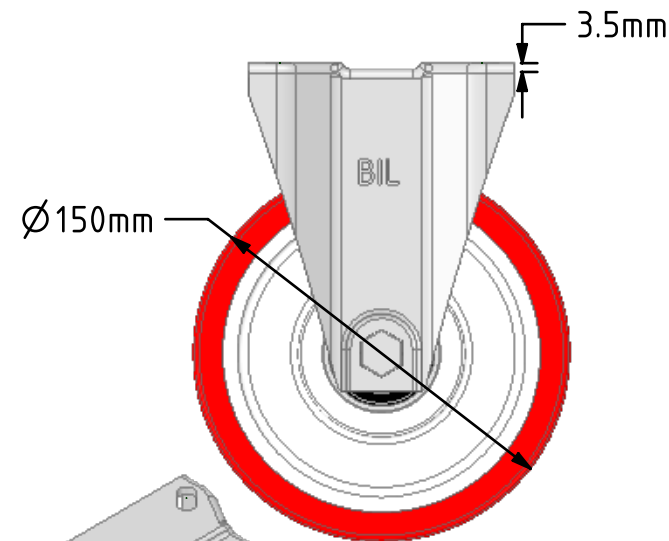
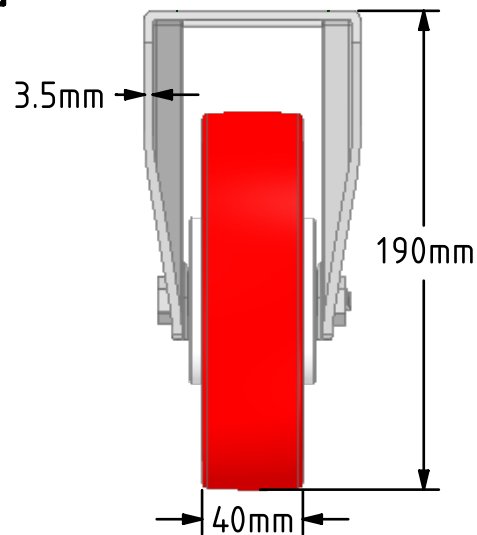
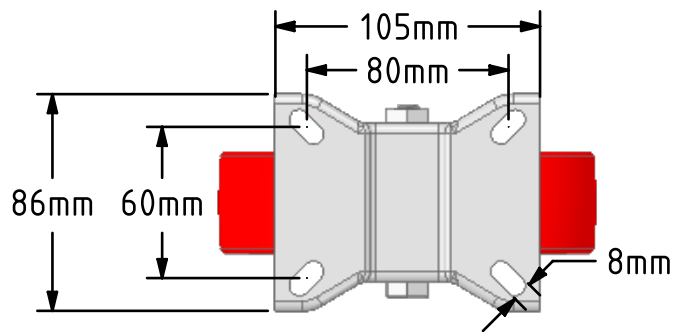

	NAME	DATE
DRAWN	Matt	22/10/18
APPROVED BY	Chris	22/10/18
SCALE	1:3	22/10/18
WEIGHT	1.529kg	22/10/18

 BIL Group Ltd, Porte Marsh Road, Calne Wiltshire, SN11 9BW, United Kingdom  
 Tel +44 (0)1249 822 222 Fax: +44 (0)1249 822 300  
 www.bilgroup.co.uk

TITLE		
BZPHFL150NPBJ		
SIZE	DWG NO.	REV
A4	BILCW03BZPHFL150NPBJ__01	1
FILE NAME	BILCW03BZPHFL150NPBJ__01.PDF SHEET 1 OF 1	

UNLESS OTHERWISE SPECIFIED DIMENSIONS ARE IN MILLIMETRES  
 Unspecified Tolerances  
 Machining ± 0.25mm  
 Fabrication ± 1mm