

DRAWING DISCLAIMER

COPYRIGHT OF THIS DRAWING IS RESERVED BY BIL GROUP LTD. IT IS ISSUED ON CONDITION THAT IT IS NOT REPRODUCED, COPIED, OR DISCLOSED TO A THIRD PARTY EITHER WHOLLY OR IN PART WITHOUT THE CONSENT IN WRITING OF BIL GROUP LTD.

**Description:****BZPHF125NPBJ**

Pressed steel fixed castor fitted with a red polyurethane tyre on a white nylon centred wheel, 100mm overall wheel diameter, 40mm tread width, 158mm overall height, 135mm x 110mm top plate with hole centres of 105mm x 80mm and a load capacity of 350kg.

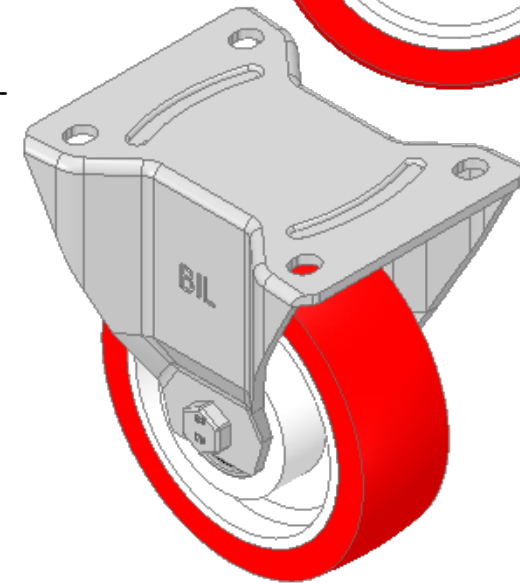
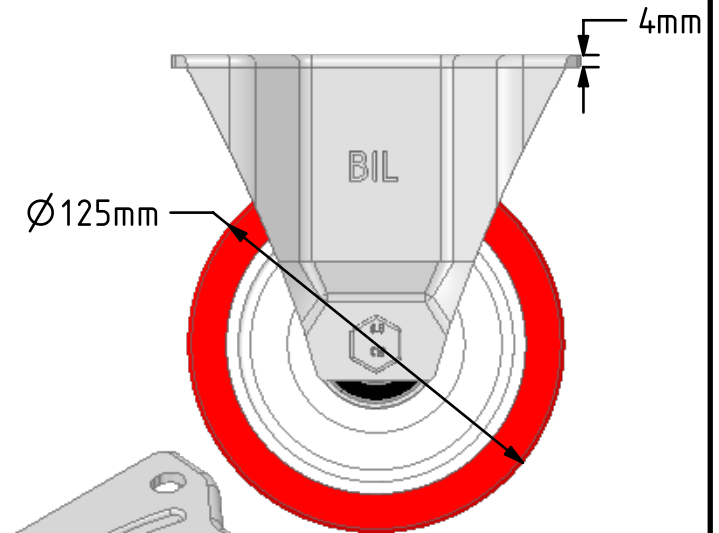
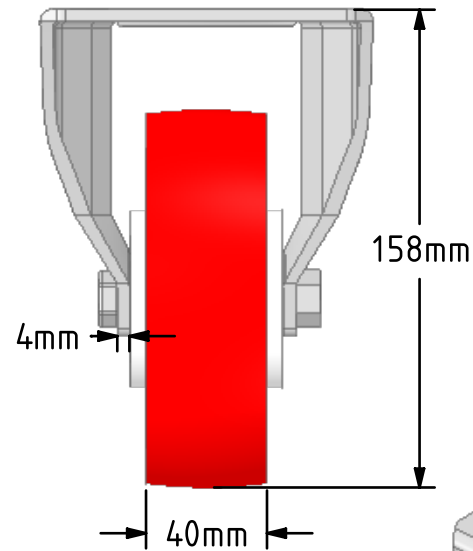
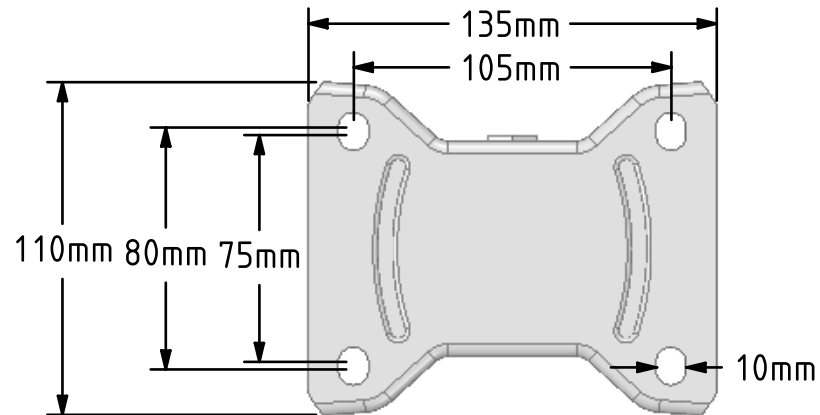

	NAME	DATE
DRAWN	Matt	27/11/18
APPROVED BY	Chris	27/11/18
SCALE	2:5	27/11/18
WEIGHT	1.305kg	27/11/18

UNLESS OTHERWISE SPECIFIED DIMENSIONS ARE IN MILLIMETRES

Unspecified Tolerances
Machining $\pm 0.25\text{mm}$
Fabrication $\pm 1\text{mm}$



BIL Group Ltd, Porte Marsh Road, Calne
Wiltshire, SN11 9BW, United Kingdom
Tel +44 (0)1249 822 222 Fax: +44 (0)1249 822 300
www.bilgroup.co.uk

TITLE

BZPHF125NPBJ

SIZE

DWG NO.

A4

BILCW03BZPHF125NPBJ_01

REV

1

FILE NAME BILCW03BZPHF125NPBJ_01.PDF

SHEET 1 OF 1