

**DRAWING DISCLAIMER**  
 COPYRIGHT OF THIS DRAWING IS RESERVED BY BIL GROUP LTD. IT IS ISSUED ON CONDITION THAT IT IS NOT REPRODUCED, COPIED, OR DISCLOSED TO A THIRD PARTY EITHER WHOLLY OR IN PART WITHOUT THE CONSENT IN WRITING OF BIL GROUP LTD.

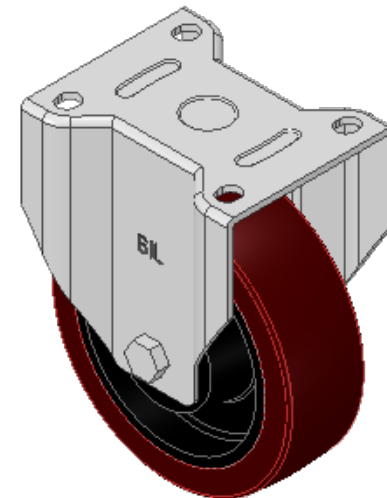

**Description:**  
 BZPF160PTBJ  
 Pressed steel fixed castor with a top plate fixing fitted with a brown polyurethane tyre on cast iron centred wheel with a ball bearing. Wheel diameter 160mm, tread width 50mm, overall height 199mm, plate size 135mm x 110mm, hole centres 105mm x 80mm. Load capacity 750kg.

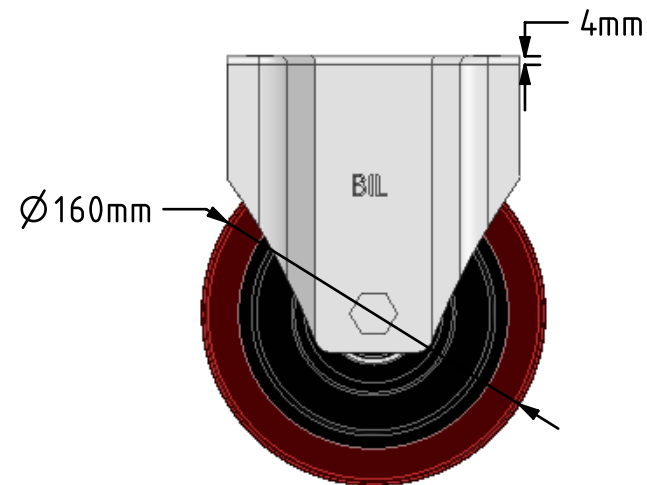
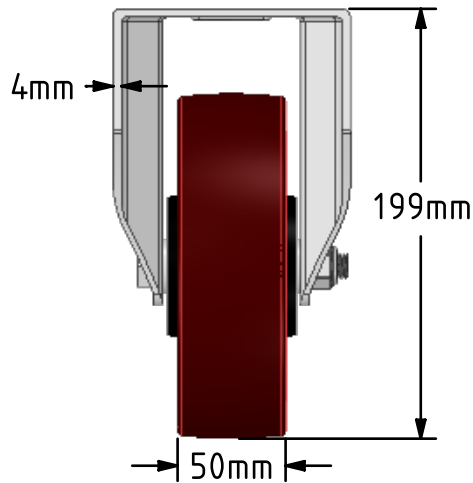
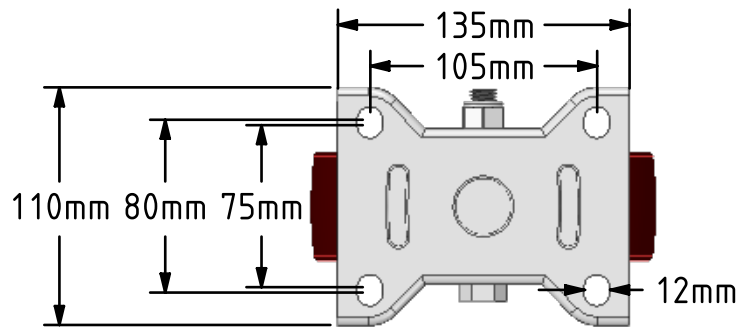

|             | NAME   | DATE     |
|-------------|--------|----------|
| DRAWN       | Matt   | 27/02/19 |
| APPROVED BY | Chris  | 27/02/19 |
| SCALE       | 2:7    | 27/02/19 |
| WEIGHT      | 4.15kg | 27/02/19 |

**BIL** BIL Group Ltd, Porte Marsh Road, Calne  
 Wiltshire, SN11 9BW, United Kingdom  
 Tel +44 (0)1249 822 222 Fax: +44 (0)1249 822 300  
 www.bilgroup.co.uk

|                           |                       |     |
|---------------------------|-----------------------|-----|
| TITLE                     |                       |     |
| BZPF160PTBJ               |                       |     |
| SIZE                      | DWG NO.               | REV |
| A4                        | BILCW03BZPF160PTBJ_01 | 1   |
| FILE NAME                 | SHEET 1 OF 1          |     |
| BILCW03BZPF160PTBJ_01.PDF |                       |     |

UNLESS OTHERWISE SPECIFIED DIMENSIONS ARE IN MILLIMETRES  
 Unspecified Tolerances  
 Machining ± 0.25mm  
 Fabrication ± 1mm