

DRAWING DISCLAIMER
 COPYRIGHT OF THIS DRAWING IS RESERVED BY BIL GROUP LTD. IT IS ISSUED ON CONDITION THAT IT IS NOT REPRODUCED, COPIED, OR DISCLOSED TO A THIRD PARTY EITHER WHOLLY OR IN PART WITHOUT THE CONSENT IN WRITING OF BIL GROUP LTD.

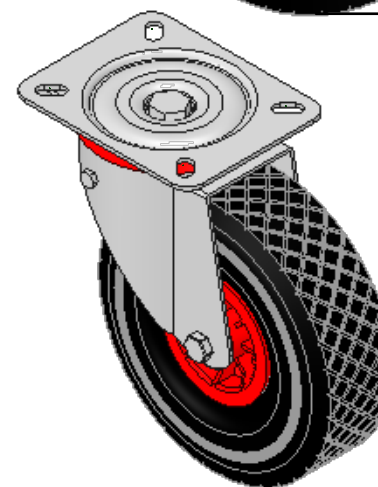

Description:
 BZPC260PPUBDSWB

Pressed steel swivel castor with a flat plate fixing fitted with a black puncture proof diamond pattern tyre on red polypropylene centred wheel with a roller bearing and total lock brake. Wheel diameter 260mm, tread width 85mm, overall height 302mm, plate size 200mm x 160mm, hole centres 150mm x 115mm, Load capacity 150kg.

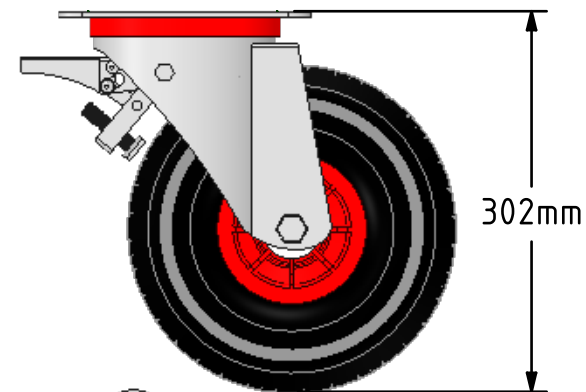
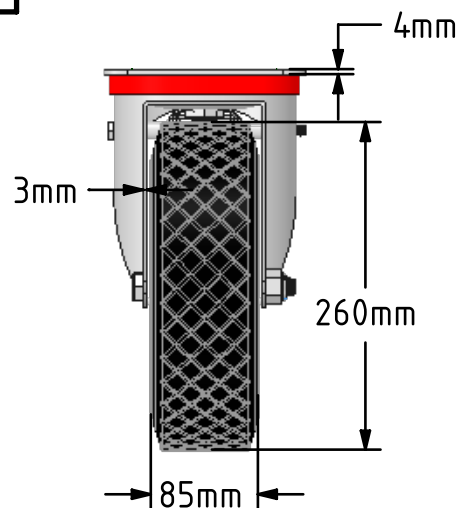
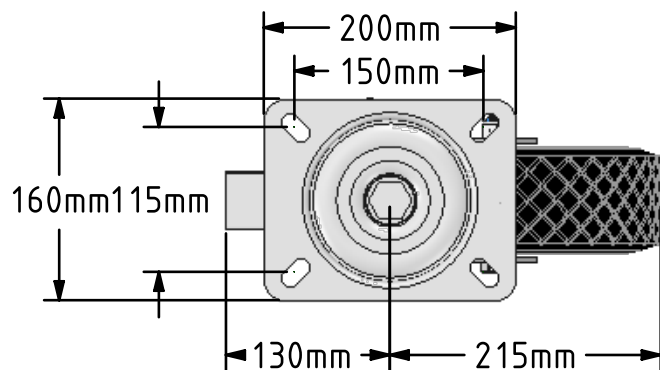

| | NAME | DATE |
|-------------|---------|----------|
| DRAWN | Matt | 27/01/17 |
| APPROVED BY | Kevin | 27/01/17 |
| SCALE | 1:6 | 27/01/17 |
| WEIGHT | 5.791kg | 27/01/17 |



BIL Group Ltd, Porte Marsh Road, Calne
 Wiltshire, SN11 9BW, United Kingdom
 Tel +44 (0)1249 822 222 Fax: +44 (0)1249 822 300
 www.bilgroup.co.uk

| TITLE | | |
|--|---------------------------|-----|
| BZPC260PPUBDSWB | | |
| SIZE | DWG NO. | REV |
| A4 | BILCW03BZPC260PPUBDSWB_01 | 1 |
| FILE NAME BILCW03BZPC260PPUBDSWB_01.PDF SHEET 1 OF 1 | | |

UNLESS OTHERWISE SPECIFIED DIMENSIONS ARE IN MILLIMETRES

Unspecified Tolerances
 Machining $\pm 0.25\text{mm}$
 Fabrication $\pm 1\text{mm}$