

DRAWING DISCLAIMER
 COPYRIGHT OF THIS DRAWING IS RESERVED BY BIL GROUP LTD. IT IS ISSUED ON CONDITION THAT IT IS NOT REPRODUCED, COPIED, OR DISCLOSED TO A THIRD PARTY EITHER WHOLLY OR IN PART WITHOUT THE CONSENT IN WRITING OF BIL GROUP LTD.

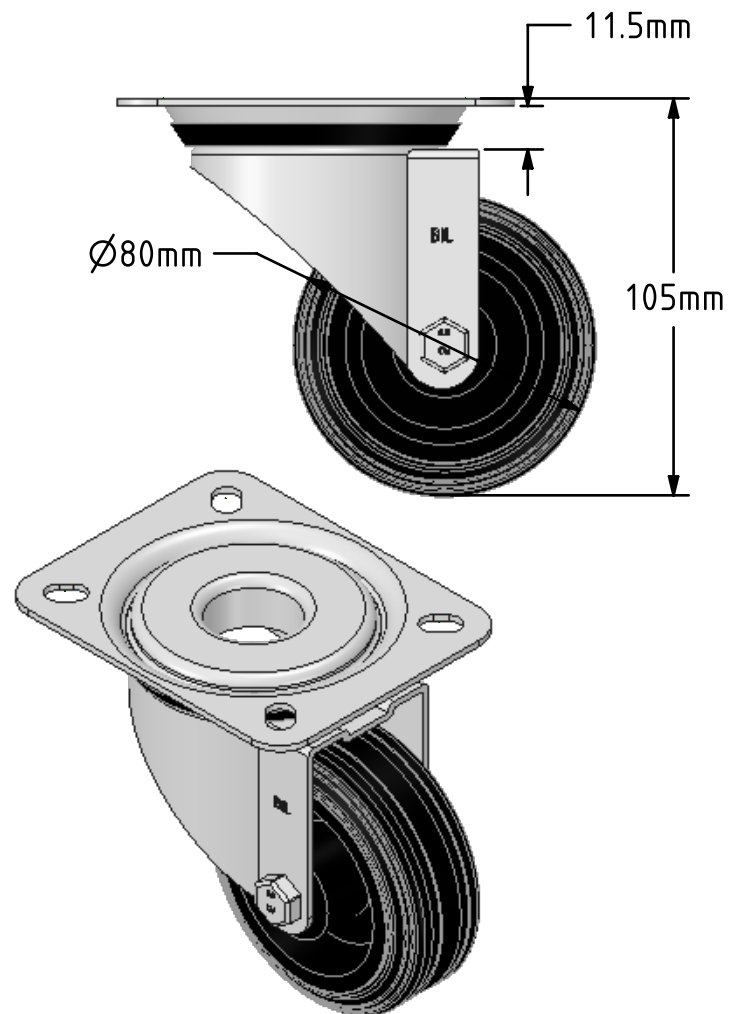

Description:
 BZMM80PSB

Pressed steel swivel castor with top plate fixing fitted with a black solid rubber tyred polypropylene centred wheel with roller bearings. Wheel diameter 80mm, tread width 29mm, overall height 105mm, top plate 105mm x 85mm, hole centres 80mm x 60mm. Load capacity 50kg.

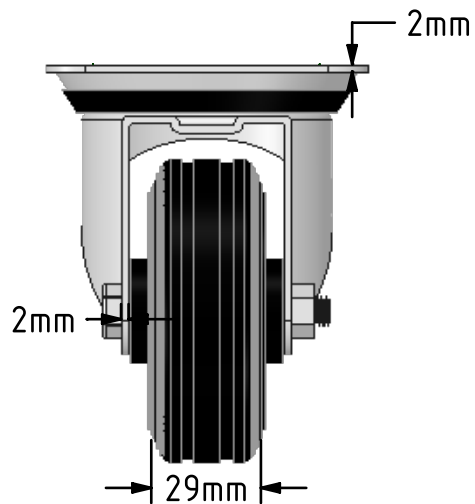
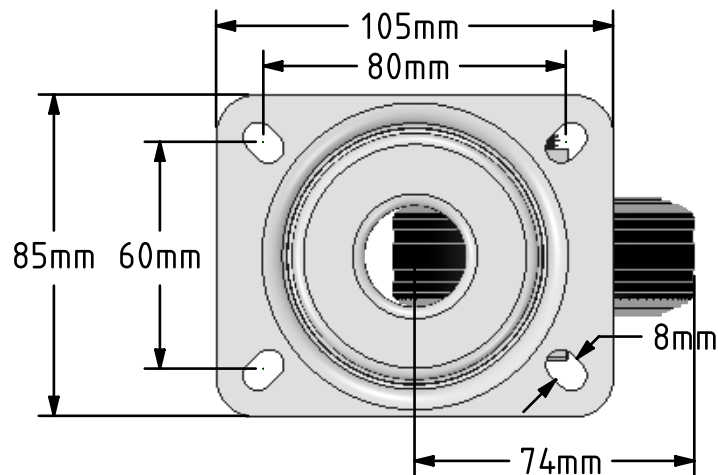

	NAME	DATE
DRAWN	Matt	02/07/18
APPROVED BY	Chris	02/07/18
SCALE	1:2	02/07/18
WEIGHT	0.573kg	02/07/18

 BIL Group Ltd, Porte Marsh Road, Calne
 Wiltshire, SN11 9BW, United Kingdom
 Tel +44 (0)1249 822 222 Fax: +44 (0)1249 822 300
 www.bilgroup.co.uk

TITLE
BZMM80PSB

UNLESS OTHERWISE SPECIFIED DIMENSIONS ARE IN MILLIMETRES
 Unspecified Tolerances
 Machining ± 0.25mm
 Fabrication ± 1mm

SIZE	DWG NO.	REV
A4	BILCW03BZMM80PSB_01	1
FILE NAME	BILCW03BZMM80PSB_01.PDF SHEET 1 OF 1	