

DRAWING DISCLAIMER  
 COPYRIGHT OF THIS DRAWING IS RESERVED BY BIL GROUP LTD. IT IS ISSUED ON CONDITION THAT IT IS NOT REPRODUCED, COPIED, OR DISCLOSED TO A THIRD PARTY EITHER WHOLLY OR IN PART WITHOUT THE CONSENT IN WRITING OF BIL GROUP LTD.

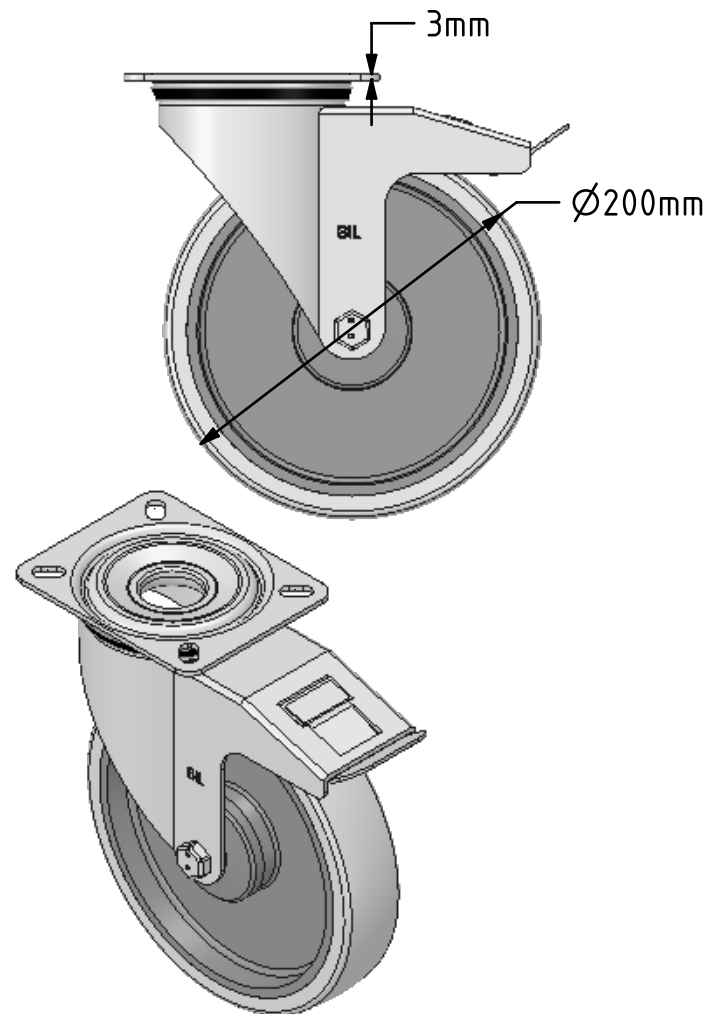

Description:  
 BZMM200STPRBJSWB

Pressed steel fixed castor with top plate fixing fitted with a 65 shore A grey thermoplastic rubber tyre on grey polypropylene centre wheel with single ball bearing with retaining caps. Wheel diameter 200mm, tread width 40mm, overall height 235mm, top plate 135mm x 110mm, hole centres 105mm x 80mm. Load capacity 220kg. REACH compliant also PAH-Free rubber to confirm to EU-directive 2005/69/EC

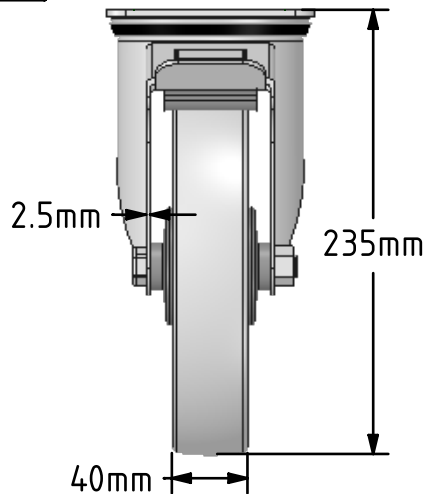
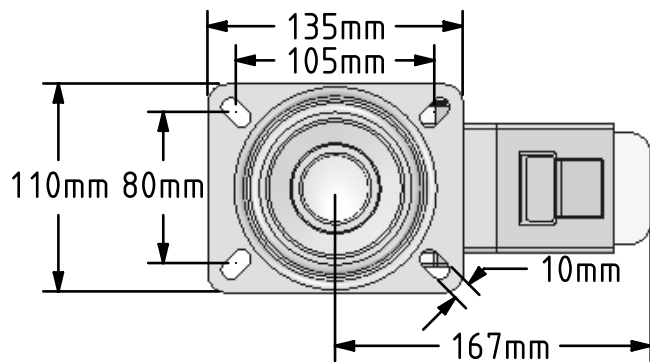

	NAME	DATE
DRAWN	Matt	17/01/18
APPROVED BY	Chris	17/01/18
SCALE	1:4	17/01/18
WEIGHT	1.992kg	17/01/18

 BIL Group Ltd, Porte Marsh Road, Calne  
 Wiltshire, SN11 9BW, United Kingdom  
 Tel +44 (0)1249 822 222 Fax: +44 (0)1249 822 300  
 www.bilgroup.co.uk

TITLE  
**BZMM200STPRBJSWB**

UNLESS OTHERWISE SPECIFIED DIMENSIONS ARE IN MILLIMETRES  
 Unspecified Tolerances  
 Machining ± 0.25mm  
 Fabrication ± 1mm

SIZE	DWG NO.	REV
A4	BILCW03BZMM200STPRBJSWB_01	1

FILE NAME BILCW03BZMM200STPRBJSWB\_01.PDF SHEET 1 OF 1