

DRAWING DISCLAIMER
 COPYRIGHT OF THIS DRAWING IS RESERVED BY BIL GROUP LTD. IT IS ISSUED ON CONDITION THAT IT IS NOT REPRODUCED, COPIED, OR DISCLOSED TO A THIRD PARTY EITHER WHOLLY OR IN PART WITHOUT THE CONSENT IN WRITING OF BIL GROUP LTD.

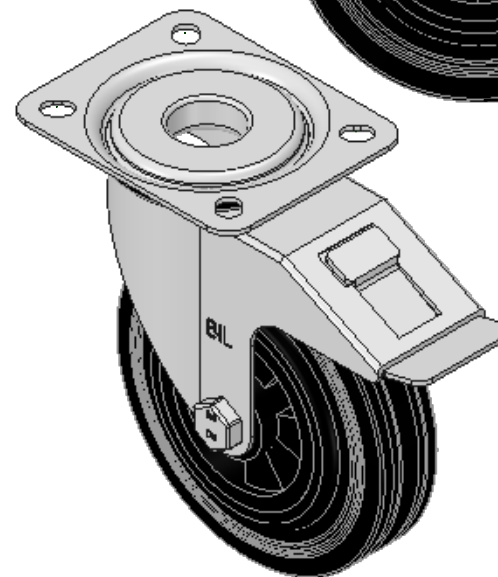

Description:
 BZMM125PSBSWB

Pressed steel swivel castor with a top plate fixing fitted with a black rubber tyre on a polypropylene centre wheel with a roller bearing and total lock brake. Wheel diameter 125mm, tread width 37.5 mm, overall height 155mm, top plate 105mm x 85mm, hole centres 80mm x 60mm. Load capacity 90kg.

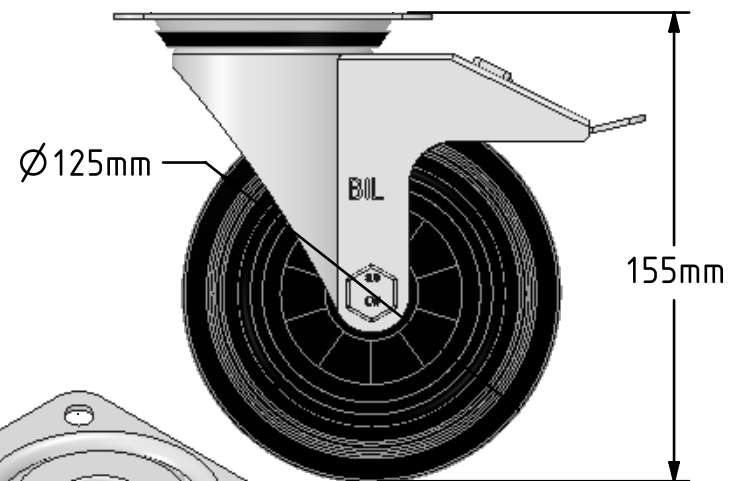
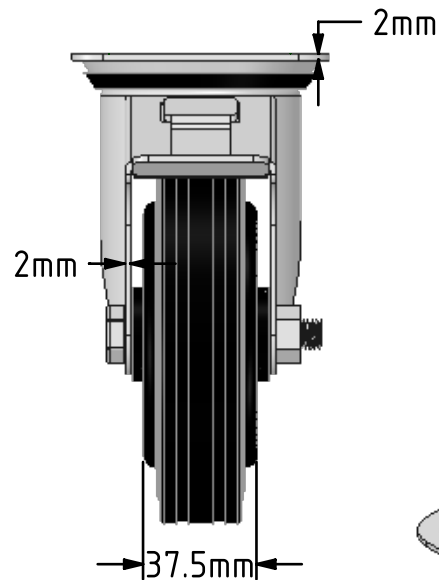
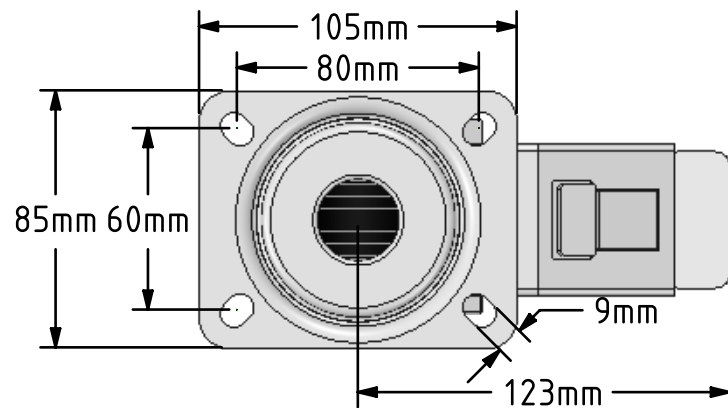

	NAME	DATE
DRAWN	Matt	02/07/18
APPROVED BY	Chris	02/07/18
SCALE	2.5	02/07/18
WEIGHT	1.118kg	02/07/18

UNLESS OTHERWISE SPECIFIED DIMENSIONS ARE IN MILLIMETRES

Unspecified Tolerances
 Machining ± 0.25mm
 Fabrication ± 1mm



BIL Group Ltd, Porte Marsh Road, Calne
 Wiltshire, SN11 9BW, United Kingdom
 Tel +44 (0)1249 822 222 Fax: +44 (0)1249 822 300
 www.bilgroup.co.uk

TITLE

BZMM125PSBSWB

SIZE DWG NO.

A4

BILCW03BZMM125PSBSWB_01

REV

1

FILE NAME BILCW03BZMM125PSBSWB_01.PDF

SHEET 1 OF 1