

DRAWING DISCLAIMER
 COPYRIGHT OF THIS DRAWING IS RESERVED BY BIL GROUP LTD. IT IS ISSUED ON CONDITION THAT IT IS NOT REPRODUCED, COPIED, OR DISCLOSED TO A THIRD PARTY EITHER WHOLLY OR IN PART WITHOUT THE CONSENT IN WRITING OF BIL GROUP LTD.

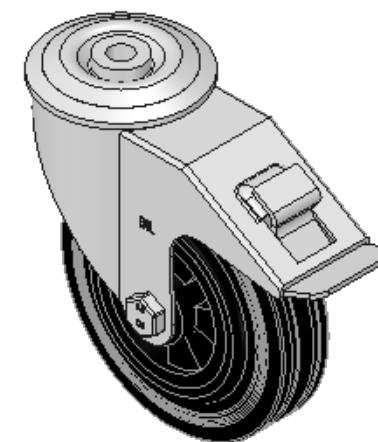

Description:
 BZMM125PSBBH12SW

Pressed steel swivel castor with a 12mm bolt hole fitted with a black rubber tyre on a polypropylene centre wheel with a roller bearing and total lock brake. Wheel diameter 125mm, tread width 37.5 mm, overall height 155mm, Load capacity 90kg.

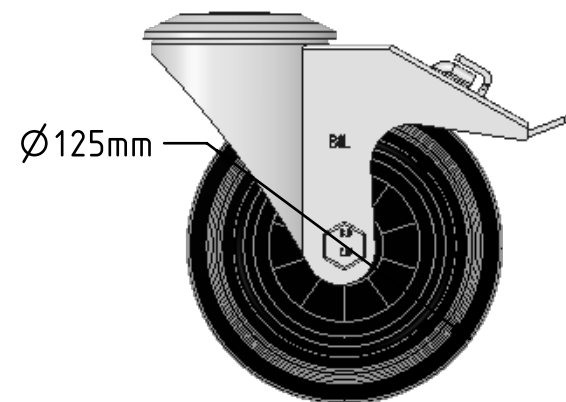
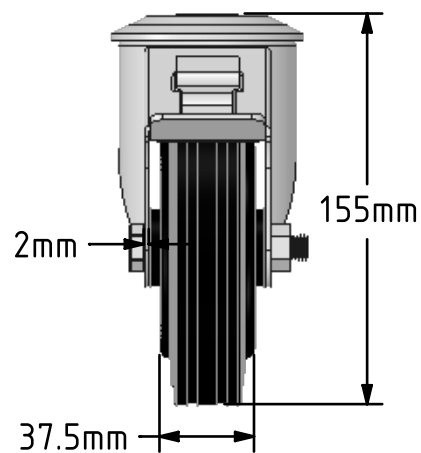
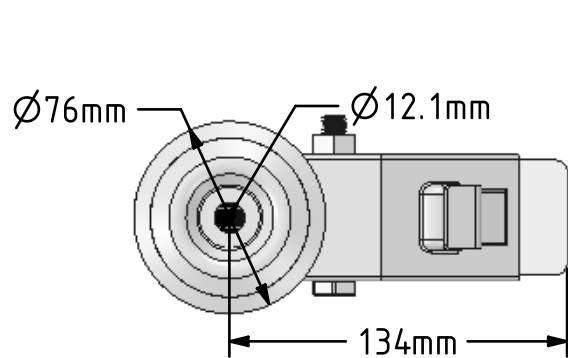

	NAME	DATE
DRAWN	Matt	11/04/18
APPROVED BY	Tim W	11/04/18
SCALE	1:3	11/04/18
WEIGHT	1.181kg	11/04/18

 BIL Group Ltd, Porte Marsh Road, Calne
 Wiltshire, SN11 9BW, United Kingdom
 Tel +44 (0)1249 822 222 Fax: +44 (0)1249 822 300
 www.bilgroup.co.uk

TITLE	BZMM125PSBBH12SW	
-------	------------------	--

UNLESS OTHERWISE SPECIFIED DIMENSIONS ARE IN MILLIMETRES Unspecified Tolerances Machining ± 0.25mm Fabrication ± 1mm	SIZE	DWG NO.	REV
	A4	BILCW03BZMM125PSBBH12SW_01	1
FILE NAME BILCW03BZMM125PSBBH12SW_01.PDF SHEET 1 OF 1			