

**DRAWING DISCLAIMER**  
 COPYRIGHT OF THIS DRAWING IS RESERVED BY BIL GROUP LTD. IT IS ISSUED ON CONDITION THAT IT IS NOT REPRODUCED, COPIED, OR DISCLOSED TO A THIRD PARTY EITHER WHOLLY OR IN PART WITHOUT THE CONSENT IN WRITING OF BIL GROUP LTD.

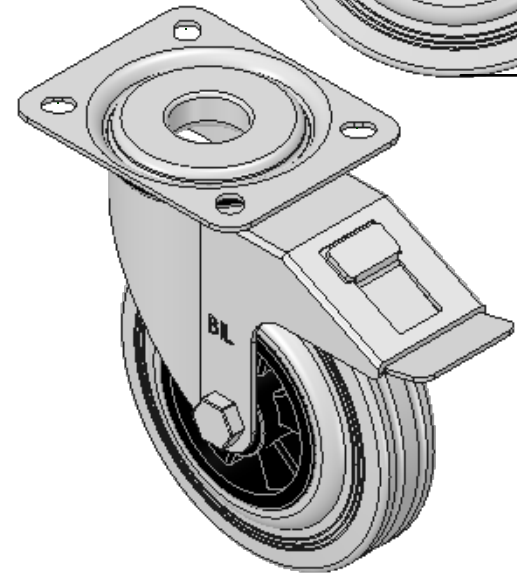

**Description:**  
 BZMM125GRSWB

Pressed steel swivel castor with a top plate fixing fitted with a grey rubber tyre on black polypropylene centred wheel with a plain bearing and total lock brake. Wheel diameter 125mm, tread width 37.5mm, overall height 155mm, top plate 105mm x 85mm, hole centres 80mm x 60mm. Load capacity 90kg.

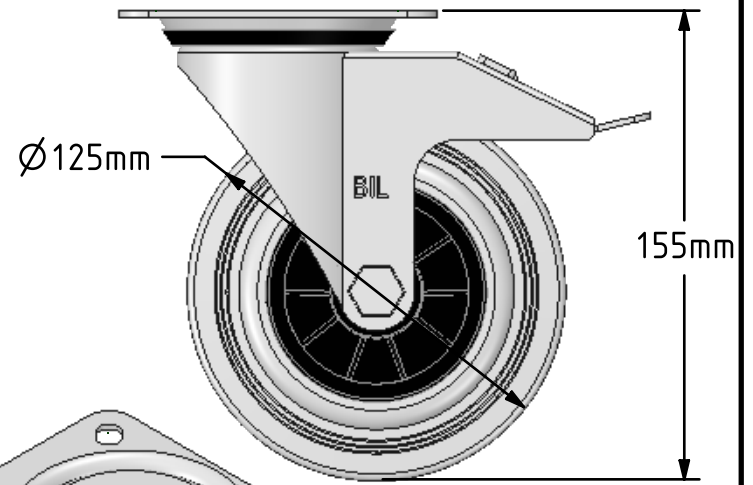
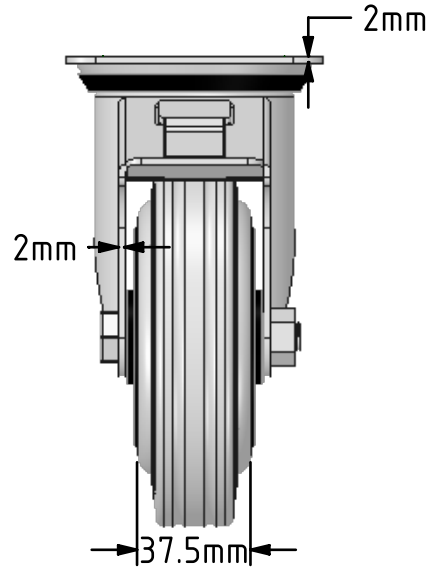
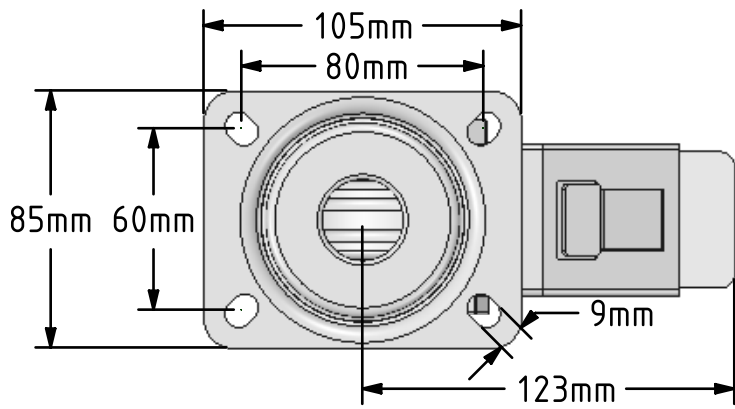

	NAME	DATE
DRAWN	Matt	03/07/18
APPROVED BY	Chris	03/07/18
SCALE	2:5	03/07/18
WEIGHT	1.136kg	03/07/18

UNLESS OTHERWISE SPECIFIED DIMENSIONS ARE IN MILLIMETRES

Unspecified Tolerances  
 Machining ± 0.25mm  
 Fabrication ± 1mm

 BIL Group Ltd, Porte Marsh Road, Calne Wiltshire, SN11 9BW, United Kingdom  
 Tel +44 (0)1249 822 222 Fax: +44 (0)1249 822 300  
 www.bilgroup.co.uk

TITLE		REV
BZMM125GRSWB		1
SIZE	DWG NO.	FILE NAME
A4	BILCW03BZMM125GRSWB__01	BILCW03BZMM125GRSWB__01.PDF
		SHEET 1 OF 1