

DRAWING DISCLAIMER
 COPYRIGHT OF THIS DRAWING IS RESERVED BY BIL GROUP LTD. IT IS ISSUED ON CONDITION THAT IT IS NOT REPRODUCED, COPIED, OR DISCLOSED TO A THIRD PARTY EITHER WHOLLY OR IN PART WITHOUT THE CONSENT IN WRITING OF BIL GROUP LTD.

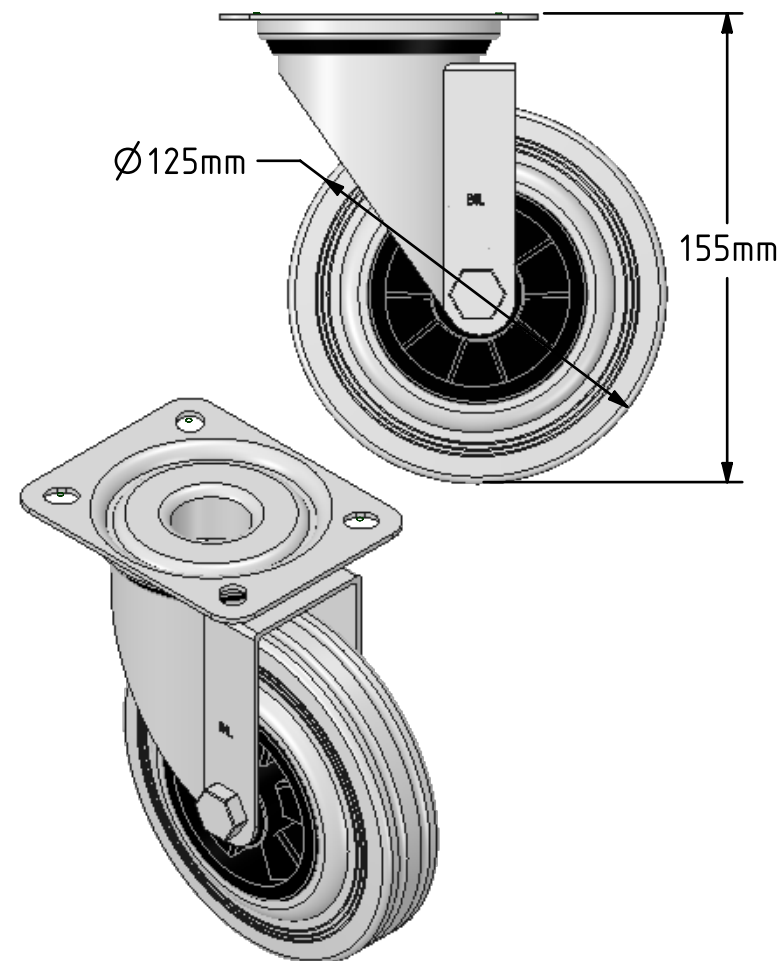

Description:
 BZMM125GR

Pressed steel swivel castor, fitted with a top plate and 125mm grey rubber on black polypropylene wheel, 37.5mm tread width, 155mm overall height, 105 x 85mm top plate, 80 x 60mm bolt holes, with a load capacity of 90kgs.

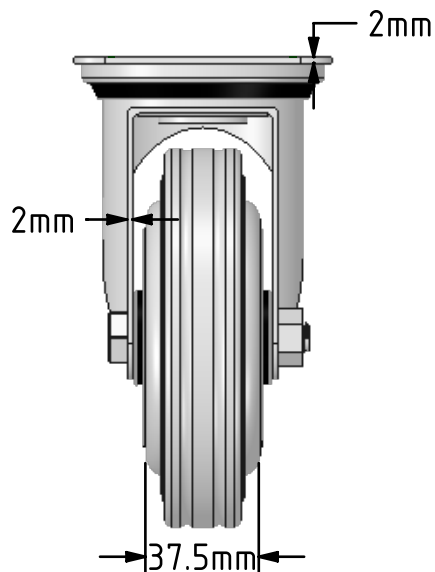
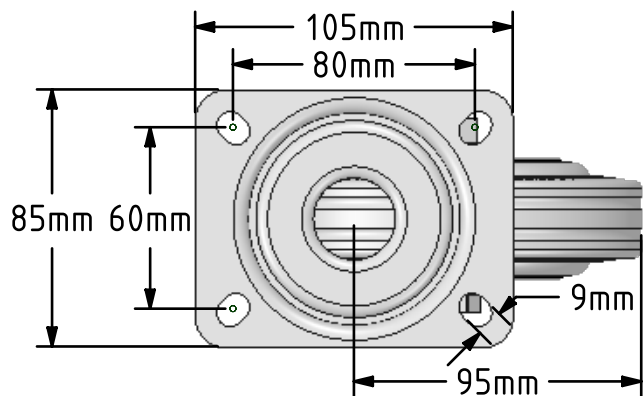

	NAME	DATE
DRAWN	Matt	03/07/18
APPROVED BY	Chris	03/07/18
SCALE	2.5	03/07/18
WEIGHT	0.935kg	03/07/18

UNLESS OTHERWISE SPECIFIED DIMENSIONS ARE IN MILLIMETRES

Unspecified Tolerances
 Machining ± 0.25mm
 Fabrication ± 1mm



BIL Group Ltd, Porte Marsh Road, Calne
 Wiltshire, SN11 9BW, United Kingdom
 Tel +44 (0)1249 822 222 Fax: +44 (0)1249 822 300
 www.bilgroup.co.uk

TITLE

BZMM125GR

SIZE DWG NO.

A4

BILCW03BZMM125GR_01

REV

1

FILE NAME

BILCW03BZMM125GR_01.PDF

SHEET 1 OF 1