

DRAWING DISCLAIMER
 COPYRIGHT OF THIS DRAWING IS RESERVED BY BIL GROUP LTD. IT IS ISSUED ON CONDITION THAT IT IS NOT REPRODUCED, COPIED, OR DISCLOSED TO A THIRD PARTY EITHER WHOLLY OR IN PART WITHOUT THE CONSENT IN WRITING OF BIL GROUP LTD.

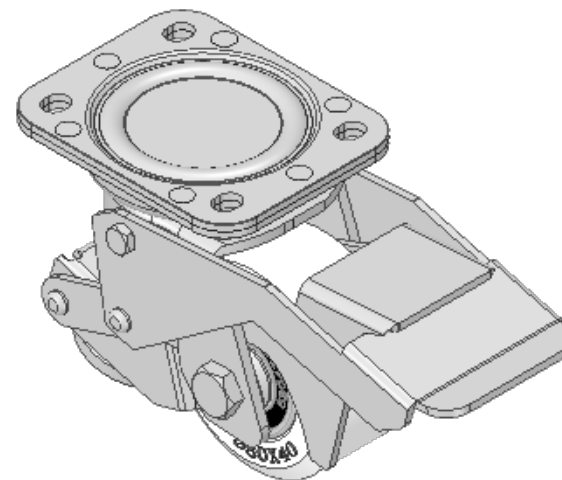

Description:
 BZLC80NYBJ

Pressed steel swivel "Lifting Castor" with a top plate fixing fitted with a white nylon wheel with double ball bearing. Wheel diameter 80mm, tread width 40mm, overall height retracted 115mm, extended 120mm, plate size 105mm x 85mm, hole centres 80mm x 60mm. Load capacity 400kg.

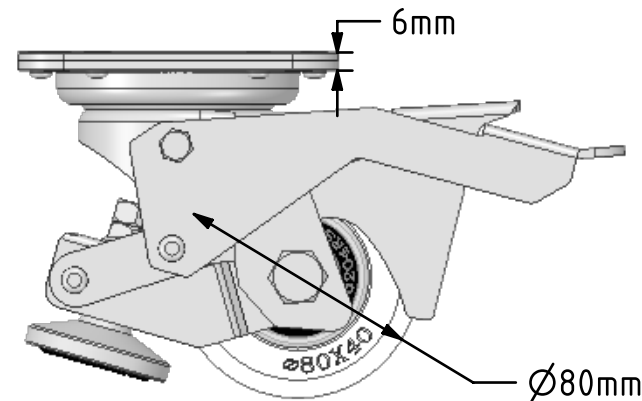
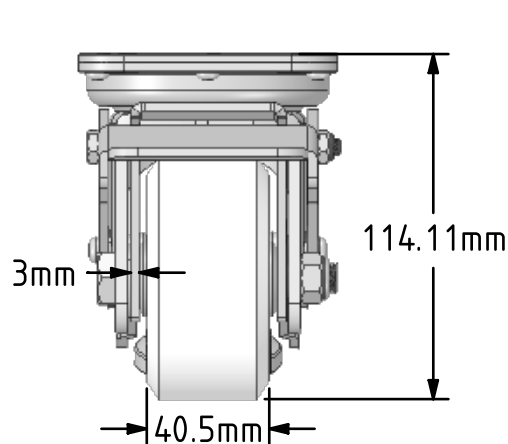
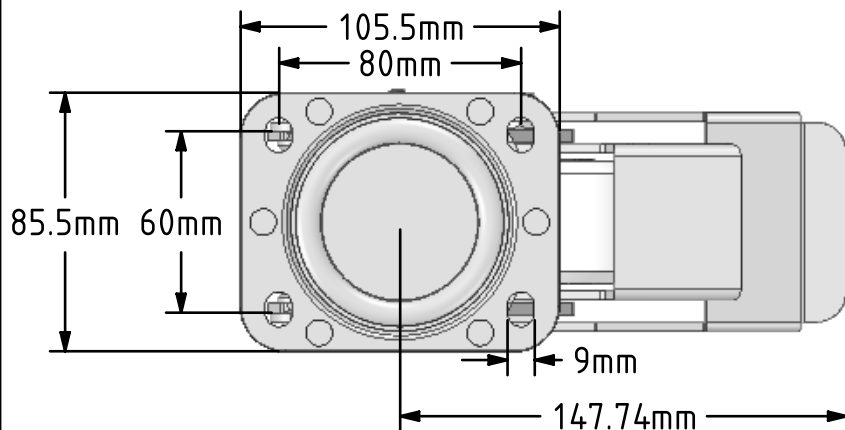

	NAME	DATE
DRAWN	Matt	25/04/19
APPROVED BY	Chris	25/04/19
SCALE	2:5	25/04/19
WEIGHT	2.157kg	25/04/19

UNLESS OTHERWISE SPECIFIED DIMENSIONS ARE IN MILLIMETRES

Unspecified Tolerances
 Machining ± 0.25mm
 Fabrication ± 1mm



BIL Group Ltd, Porte Marsh Road, Calne
 Wiltshire, SN11 9BW, United Kingdom
 Tel +44 (0)1249 822 222 Fax: +44 (0)1249 822 300
 www.bilgroup.co.uk

TITLE

BZLC80NYBJ

SIZE A4

DWG NO. BILCW03BZLC80NYBJ_01

REV 1

FILE NAME BILCW03BZLC80NYBJ_01.PDF

SHEET 1 OF 1