

DRAWING DISCLAIMER

COPYRIGHT OF THIS DRAWING IS RESERVED BY BIL GROUP LTD. IT IS ISSUED ON CONDITION THAT IT IS NOT REPRODUCED, COPIED, OR DISCLOSED TO A THIRD PARTY EITHER WHOLLY OR IN PART WITHOUT THE CONSENT IN WRITING OF BIL GROUP LTD.

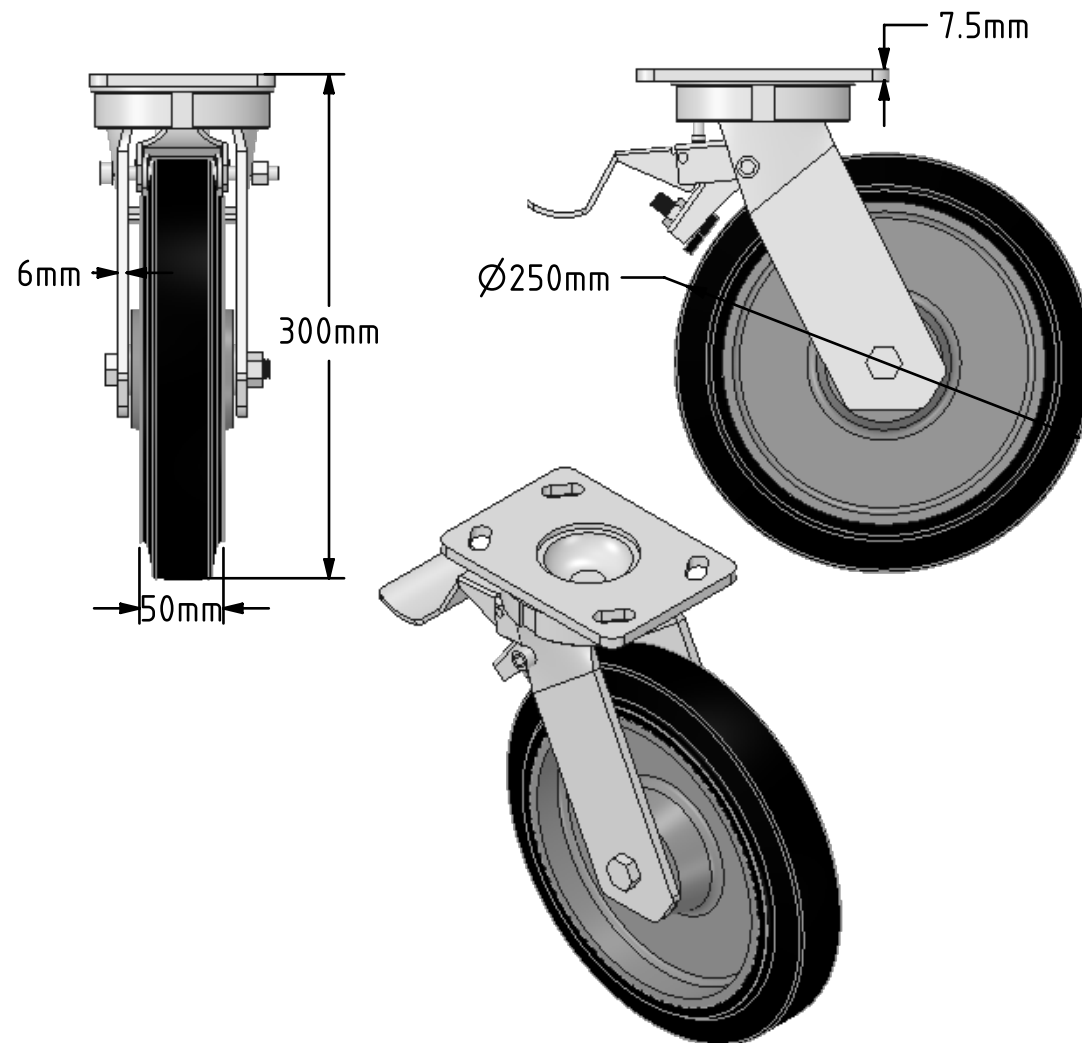
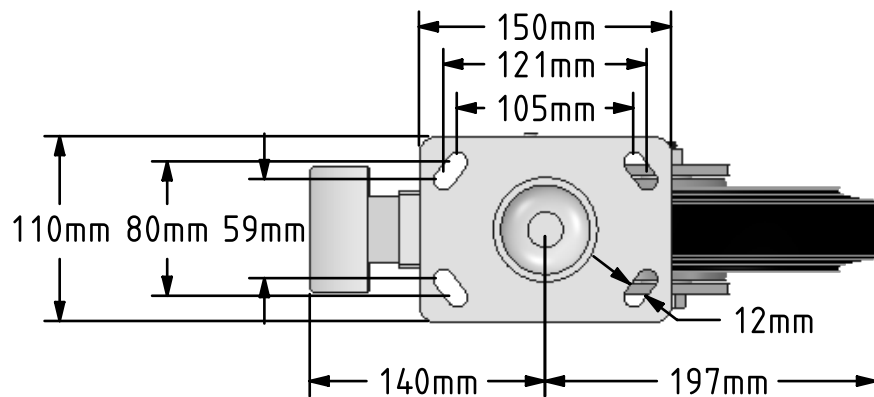

Description:
BZK250CUBJSWB

Fabricated swivel castor with a top plate fixing fitted with a 65 Shore A black elastic rubber tyre on cast iron centred wheel with ball bearings and a total lock brake. Wheel diameter 250mm, tread width 50mm, overall height 300mm, top plate 150mm x 110mm, hole centres 105mm x 80mm or 121mm x 59mm. Load capacity 550kg.
 - At 6 kph speed, the load of each wheel is advised to be 80% of the load at 4kph.
 - At 10 kph speed, the load of each wheel is advised to be 55% of the load at 4 kph.
 - At 16 kph speed, the load of each wheel is advised to be 45% of the load at 4kph.
 - At 20 kph speed, the load of each wheel is advised to be 35% of the load at 4 kph.
 - No data for elastic rubber wheel over 20 kph.



	NAME	DATE
DRAWN	Matt	11/07/18
APPROVED BY	Chris	11/07/18
SCALE	2:9	11/07/18
WEIGHT	9.167kg	11/07/18

 BIL Group Ltd, Porte Marsh Road, Calne
Wiltshire, SN11 9BW, United Kingdom
Tel +44 (0)1249 822 222 Fax: +44 (0)1249 822 300
www.bilgroup.co.uk

TITLE	BZK250CUBJSWB	
-------	---------------	--

UNLESS OTHERWISE SPECIFIED DIMENSIONS ARE IN MILLIMETRES
 Unspecified Tolerances
 Machining ± 0.25mm
 Fabrication ± 1mm

SIZE	DWG NO.	REV
A4	BILCW03BZK250CUBJSWB__01	1
FILE NAME	BILCW03BZK250CUBJSWB__01.PDF SHEET 1 OF 1	