

DRAWING DISCLAIMER
 COPYRIGHT OF THIS DRAWING IS RESERVED BY BIL GROUP LTD. IT IS ISSUED ON CONDITION THAT IT IS NOT REPRODUCED, COPIED, OR DISCLOSED TO A THIRD PARTY EITHER WHOLLY OR IN PART WITHOUT THE CONSENT IN WRITING OF BIL GROUP LTD.

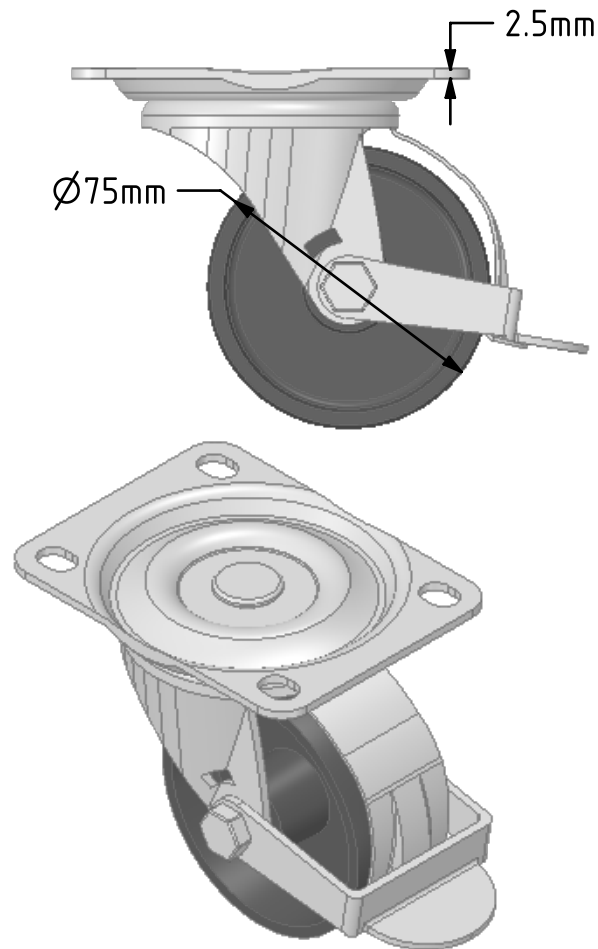

Description:
 BZH75CIBR

Pressed steel swivel castor with a top plate fixing fitted with a black cast iron with a plain bearing and wheel brake. Wheel diameter 75mm, tread width 32mm, overall height 95mm, top plate 105mm x 80mm, hole centres 86/80mm x 60mm. Load capacity 125kg.

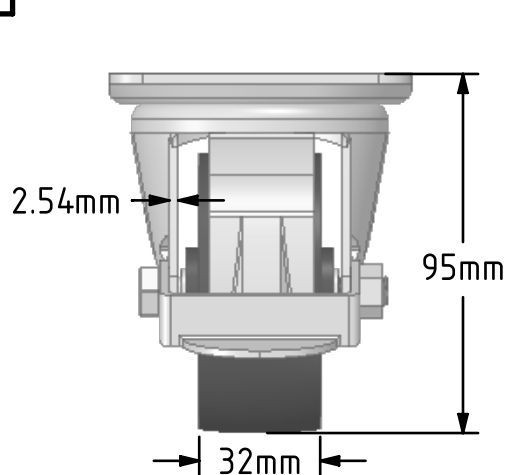
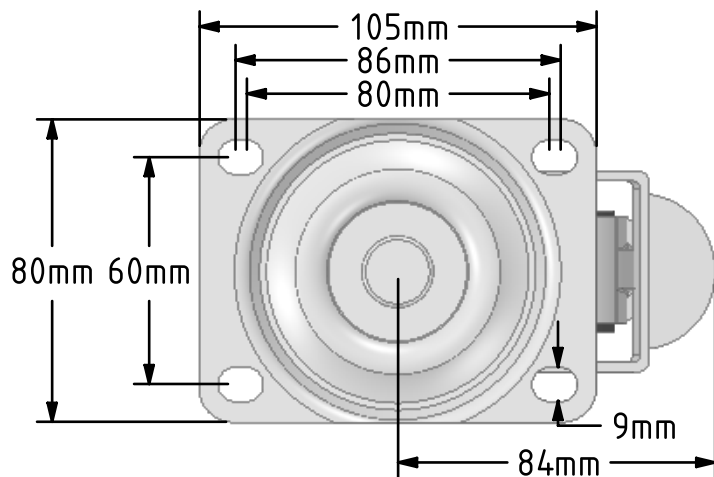

	NAME	DATE
DRAWN	Matt	19/09/18
APPROVED BY	Chris	19/09/18
SCALE	1:2	19/09/18
WEIGHT	0.882kg	19/09/18

UNLESS OTHERWISE SPECIFIED DIMENSIONS ARE IN MILLIMETRES

Unspecified Tolerances
 Machining ± 0.25mm
 Fabrication ± 1mm



BIL Group Ltd, Porte Marsh Road, Calne
 Wiltshire, SN11 9BW, United Kingdom
 Tel +44 (0)1249 822 222 Fax: +44 (0)1249 822 300
 www.bilgroup.co.uk

TITLE

BZH75CIBR

SIZE	DWG NO.	REV
A4	BILCW03BZH75CIBR_01	1

FILE NAME BILCW03BZH75CIBR_01.PDF SHEET 1 OF 1