

DRAWING DISCLAIMER
 COPYRIGHT OF THIS DRAWING IS RESERVED BY BIL GROUP LTD. IT IS ISSUED ON CONDITION THAT IT IS NOT REPRODUCED, COPIED, OR DISCLOSED TO A THIRD PARTY EITHER WHOLLY OR IN PART WITHOUT THE CONSENT IN WRITING OF BIL GROUP LTD.

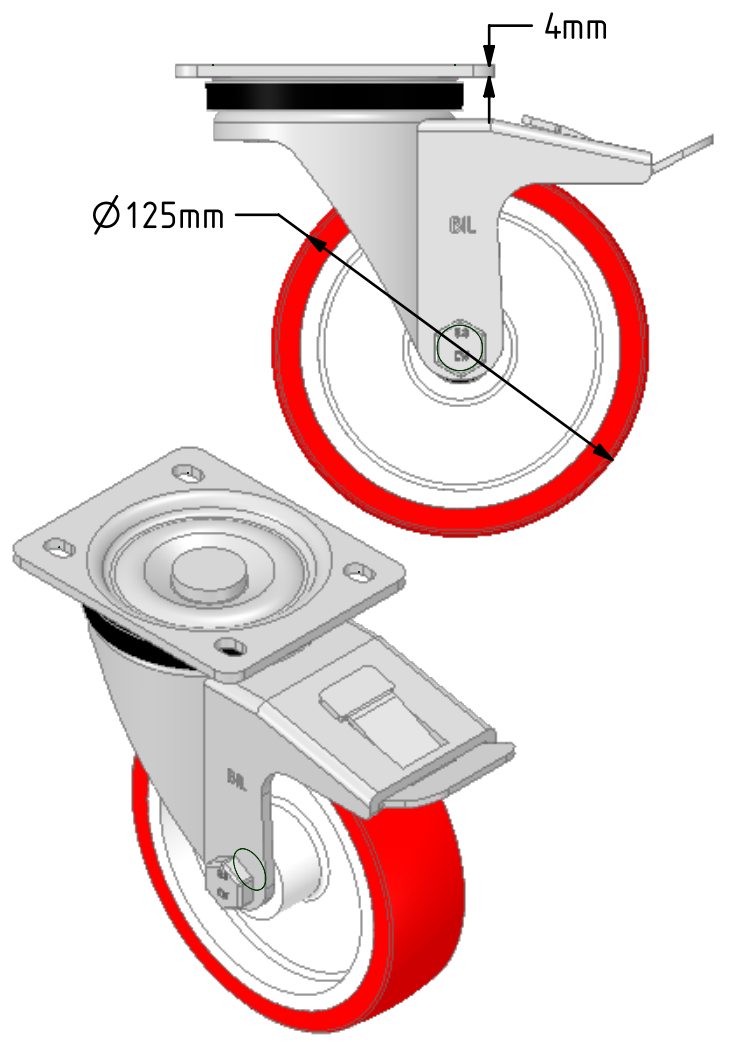

Description:
 BZH125NPBSWB
 Pressed steel swivel castor with a top plate fixing fitted with a red polyurethane tyre on white nylon centred wheels with roller bearing and swivel wheel brake. Wheel diameter 125mm, tread width 35mm, overall height 155mm, plate size 105mm x 86mm, hole centres 80mm x 60mm. Load capacity 300kg.

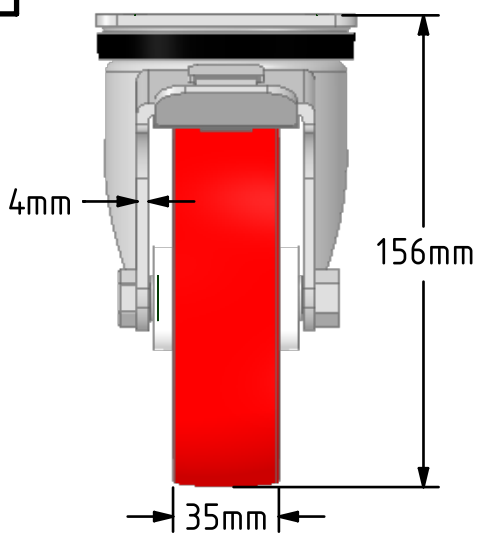
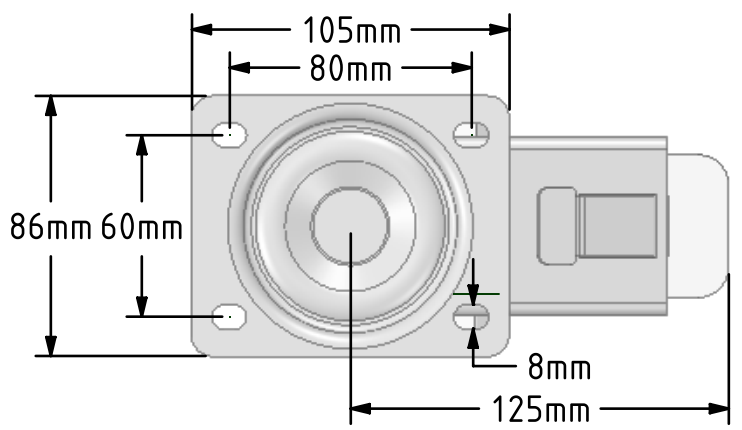

	NAME	DATE
DRAWN	Matt	19/10/18
APPROVED BY	Chris	19/10/18
SCALE	2:5	19/10/18
WEIGHT	1.397kg	19/10/18

BIL BIL Group Ltd, Porte Marsh Road, Calne
 Wiltshire, SN11 9BW, United Kingdom
 Tel +44 (0)1249 822 222 Fax: +44 (0)1249 822 300
 www.bilgroup.co.uk

UNLESS OTHERWISE SPECIFIED DIMENSIONS ARE IN MILLIMETRES
 Unspecified Tolerances
 Machining ± 0.25mm
 Fabrication ± 1mm

TITLE		REV
BZH125NPBSWB		1
SIZE	DWG NO.	
A4	BILCW03BZH125NPBSWB_01	
FILE NAME	SHEET 1 OF 1	
BILCW03BZH125NPBSWB_01.PDF		