

**DRAWING DISCLAIMER**  
 COPYRIGHT OF THIS DRAWING IS RESERVED BY BIL GROUP LTD. IT IS ISSUED ON CONDITION THAT IT IS NOT REPRODUCED, COPIED, OR DISCLOSED TO A THIRD PARTY EITHER WHOLLY OR IN PART WITHOUT THE CONSENT IN WRITING OF BIL GROUP LTD.

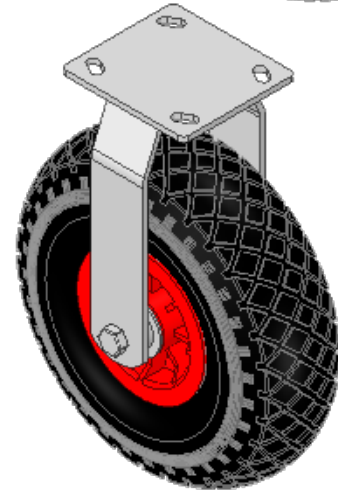

**Description:**  
 BZFPCF260PRB  
 Fabricated fixed castor with a top plate fixing fitted with a 4 ply black diamond pattern pneumatic tyre with a red polypropylene centre with roller bearing bore. Wheel diameter 260, tread width 85mm, overall height 318mm, plate size 115mm x 105mm, hole centres 92mm x 67 or 76mm x 76mm. Load capacity 120kg at max speed 4KPH, for non-towing applications

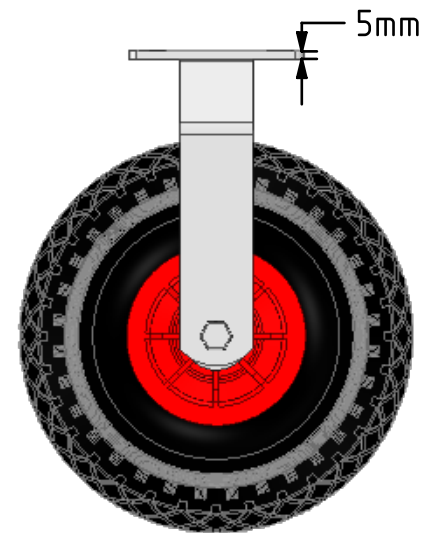
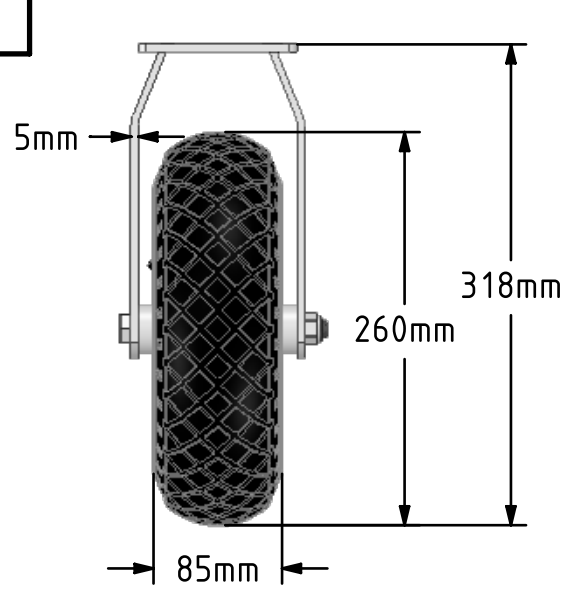
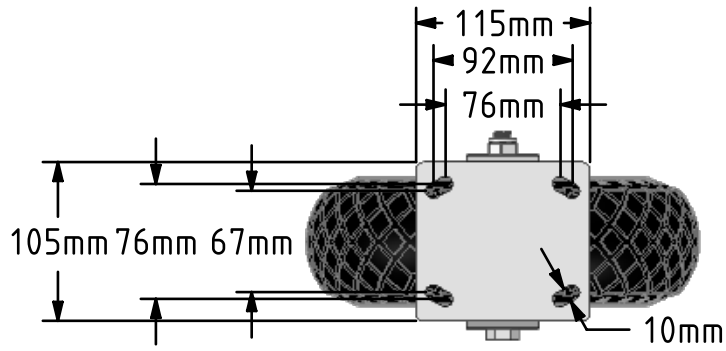

	NAME	DATE
DRAWN	Matt	05/02/19
APPROVED BY	Chris	05/02/19
SCALE	1:5	05/02/19
WEIGHT	2.851kg	05/02/19
UNLESS OTHERWISE SPECIFIED DIMENSIONS ARE IN MILLIMETRES		
Unspecified Tolerances Machining ± 0.25mm Fabrication ± 1mm		

 BIL Group Ltd, Porte Marsh Road, Calne Wiltshire, SN11 9BW, United Kingdom Tel +44 (0)1249 822 222 Fax: +44 (0)1249 822 300 www.bilgroup.co.uk	TITLE	
	BZFPCF260PRB	
SIZE	DWG NO.	REV
A4	BILCW03BZFPCF260PRB__02	2
FILE NAME	BILCW03BZFPCF260PRB__02.PDF SHEET 1 OF 1	