

DRAWING DISCLAIMER
 COPYRIGHT OF THIS DRAWING IS RESERVED BY BIL GROUP LTD. IT IS ISSUED ON CONDITION THAT IT IS NOT REPRODUCED, COPIED, OR DISCLOSED TO A THIRD PARTY EITHER WHOLLY OR IN PART WITHOUT THE CONSENT IN WRITING OF BIL GROUP LTD.

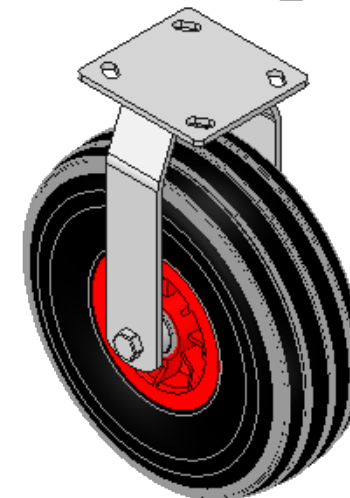

Description:
 BZFPCF260PPUB

Fabricated fixed castor with a top plate fixing fitted with a black ribbed pattern puncture proof tyre red polypropylene centred wheel with roller bearing. Wheel diameter 260, tread width 85mm, overall height 318mm, plate size 115mm x 105mm, hole centres 92mm x 67mm or 76mm x 76mm. Load capacity 120kg.

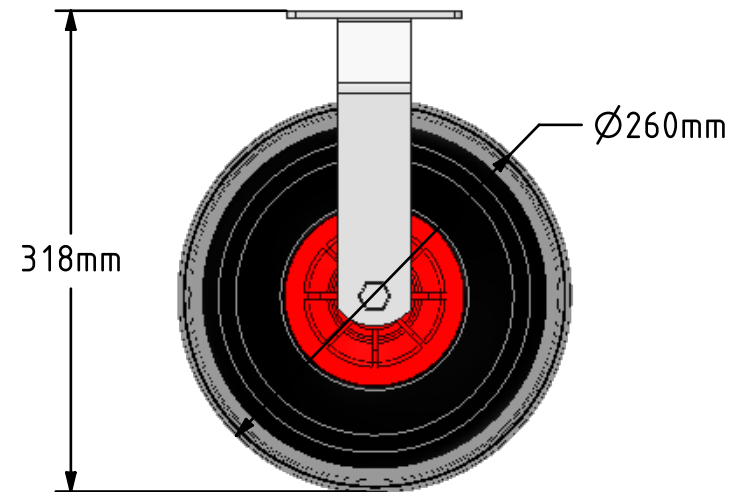
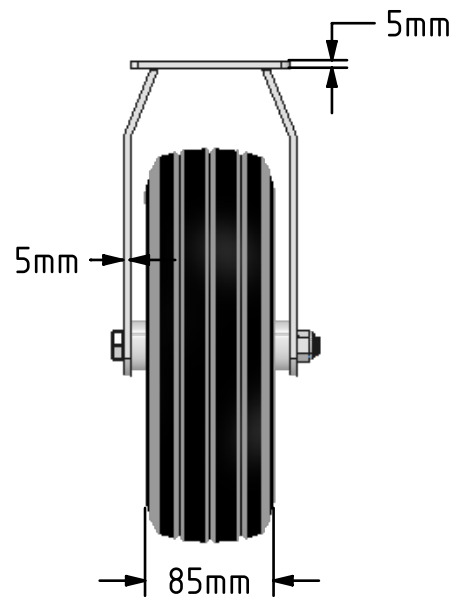
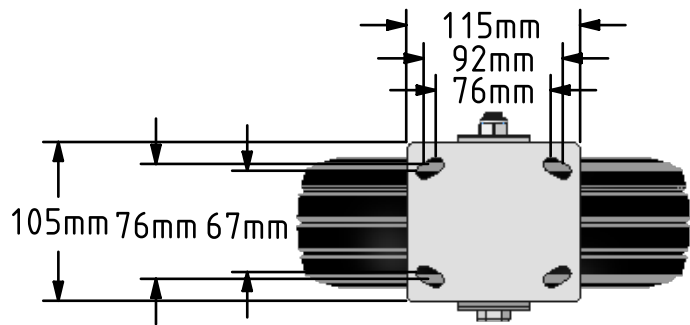
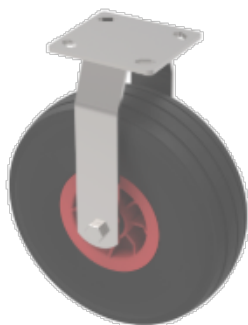

	NAME	DATE
DRAWN	Matt	15/11/16
APPROVED BY	Tim W	15/11/16
SCALE	1:5	15/11/16
WEIGHT	3.328kg	15/11/16



BIL Group Ltd, Porte Marsh Road, Calne
 Wiltshire, SN11 9BW, United Kingdom
 Tel +44 (0)1249 822 222 Fax: +44 (0)1249 822 300
 www.bilgroup.eu

TITLE	
BZFPCF260PPUB	

UNLESS OTHERWISE SPECIFIED DIMENSIONS ARE IN MILLIMETRES
 Unspecified Tolerances
 Machining ± 0.25mm
 Fabrication ± 1mm

SIZE	DWG NO.	REV
A4	BILCW03BZFPCF260PPUB_01	1
FILE NAME		SHEET 1 OF 1
BILCW03BZFPCF260PPUB_01.PDF		