

DRAWING DISCLAIMER
 COPYRIGHT OF THIS DRAWING IS RESERVED BY BIL GROUP LTD. IT IS ISSUED ON CONDITION THAT IT IS NOT REPRODUCED, COPIED, OR DISCLOSED TO A THIRD PARTY EITHER WHOLLY OR IN PART WITHOUT THE CONSENT IN WRITING OF BIL GROUP LTD.

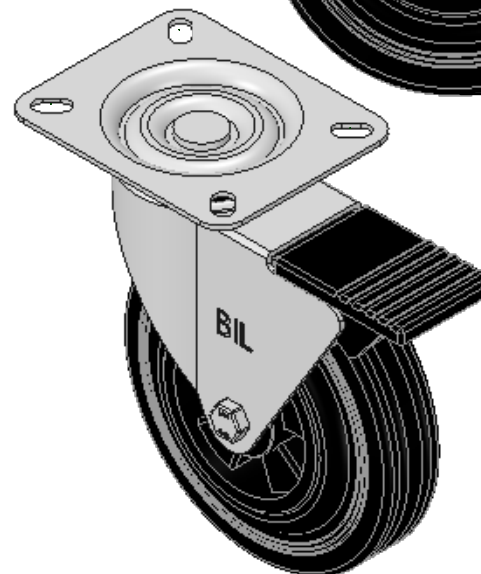

Description:
 BZBC125PSSWB

Pressed steel swivel castor with top plate fixing fitted with a black rubber tyre on black polypropylene centred wheel with a plain bearing and total lock brake. Wheel diameter 125mm, tread width 37.5mm, overall height 154mm, plate size 102mm x 84mm, hole centres 80mm x 60mm. Load capacity 90kg.

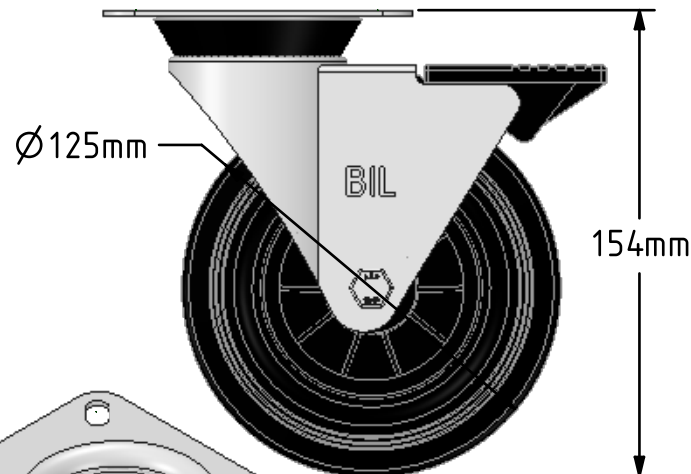
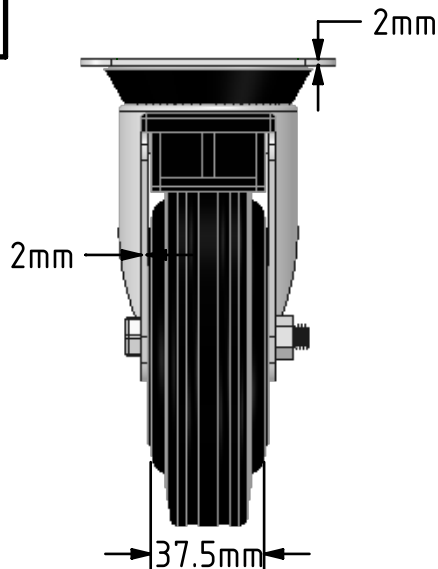
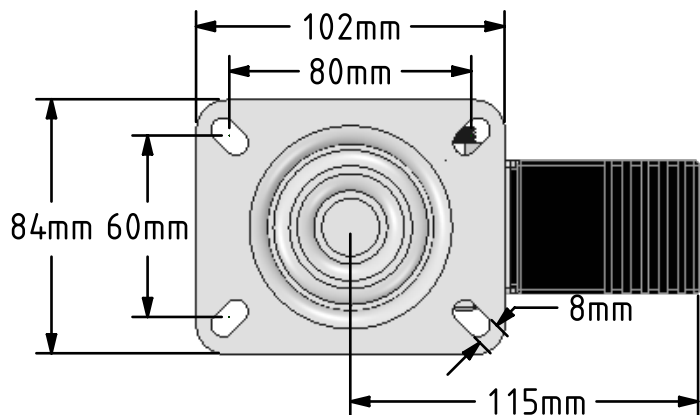

	NAME	DATE
DRAWN	Matt	25/06/18
APPROVED BY	Chris	25/06/18
SCALE	2:5	25/06/18
WEIGHT	1.042kg	25/06/18

UNLESS OTHERWISE SPECIFIED DIMENSIONS ARE IN MILLIMETRES

Unspecified Tolerances
 Machining ± 0.25mm
 Fabrication ± 1mm



BIL Group Ltd, Porte Marsh Road, Calne
 Wiltshire, SN11 9BW, United Kingdom
 Tel +44 (0)1249 822 222 Fax: +44 (0)1249 822 300
 www.bilgroup.co.uk

TITLE

BZBC125PSSWB

SIZE	DWG NO.	REV
A4	BILCW03BZBC125PSSWB_01	1

FILE NAME BILCW03BZBC125PSSWB_01.PDF SHEET 1 OF 1