

DRAWING DISCLAIMER
 COPYRIGHT OF THIS DRAWING IS RESERVED BY BIL GROUP LTD. IT IS ISSUED ON CONDITION THAT IT IS NOT REPRODUCED, COPIED, OR DISCLOSED TO A THIRD PARTY EITHER WHOLLY OR IN PART WITHOUT THE CONSENT IN WRITING OF BIL GROUP LTD.

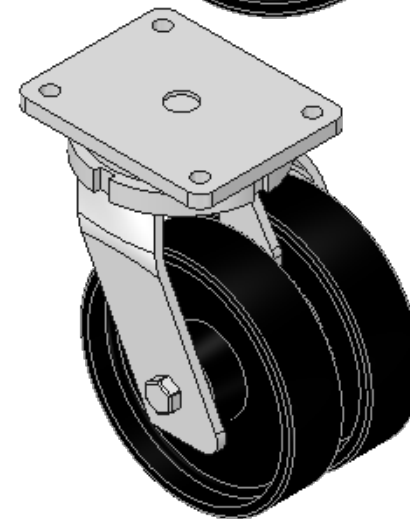

Description:
 2BZQ200CIBJ

Twin wheeled swivel castor with a top plate fixing fitted with 2 cast iron wheels with ball journal bearings. Wheel diameter 2 x 200mm, tread width 2 x 50mm, overall height 264mm, top plate 175mm x 140mm, hole centres 140mm x 105. Load capacity 2000kg.

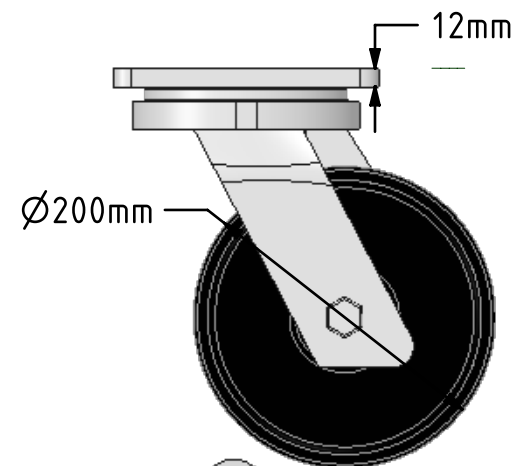
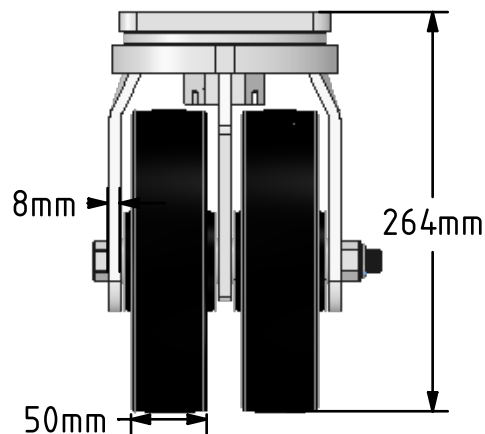
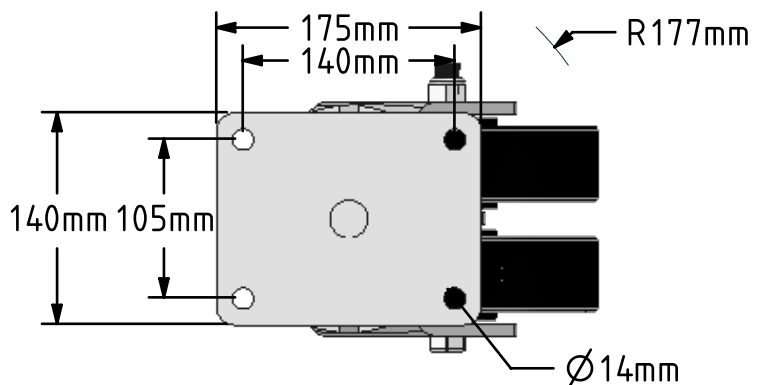

| | NAME | DATE |
|-------------|----------|----------|
| DRAWN | Matt | 31/05/18 |
| APPROVED BY | Tim W | 31/05/18 |
| SCALE | 1:5 | 31/05/18 |
| WEIGHT | 16.938kg | 31/05/18 |

UNLESS OTHERWISE SPECIFIED DIMENSIONS ARE IN MILLIMETRES

Unspecified Tolerances
 Machining ± 0.25mm
 Fabrication ± 1mm



BIL Group Ltd, Porte Marsh Road, Calne
 Wiltshire, SN11 9BW, United Kingdom
 Tel +44 (0)1249 822 222 Fax: +44 (0)1249 822 300
 www.bilgroup.co.uk

TITLE

2BZQ200CIBJ

| SIZE | DWG NO. | REV |
|------|-----------------------|-----|
| A4 | BILCW032BZQ200CIBJ_01 | 1 |

FILE NAME BILCW032BZQ200CIBJ_01.PDF SHEET 1 OF 1