

DRAWING DISCLAIMER
 COPYRIGHT OF THIS DRAWING IS RESERVED BY BIL GROUP LTD. IT IS ISSUED ON CONDITION THAT IT IS NOT REPRODUCED, COPIED, OR DISCLOSED TO A THIRD PARTY EITHER WHOLLY OR IN PART WITHOUT THE CONSENT IN WRITING OF BIL GROUP LTD.

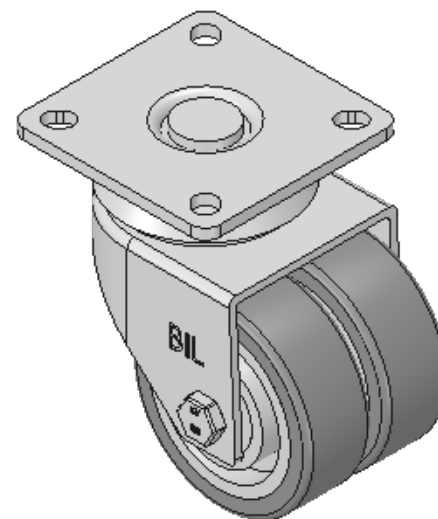

Description:
 2BZD50VGRBJ

Twin wheeled pressed steel swivel castor with a top plate fixing fitted with 2 thermoplastic grey rubber tyres on 2 grey polypropylene centred wheels with ball bearings. Wheel diameter 50mm, tread width 2 x 18mm, overall height 73mm, plate size 55mm x 55mm, hole centres 42mm x 42mm or 40mm x 40mm. Load capacity 55kg.

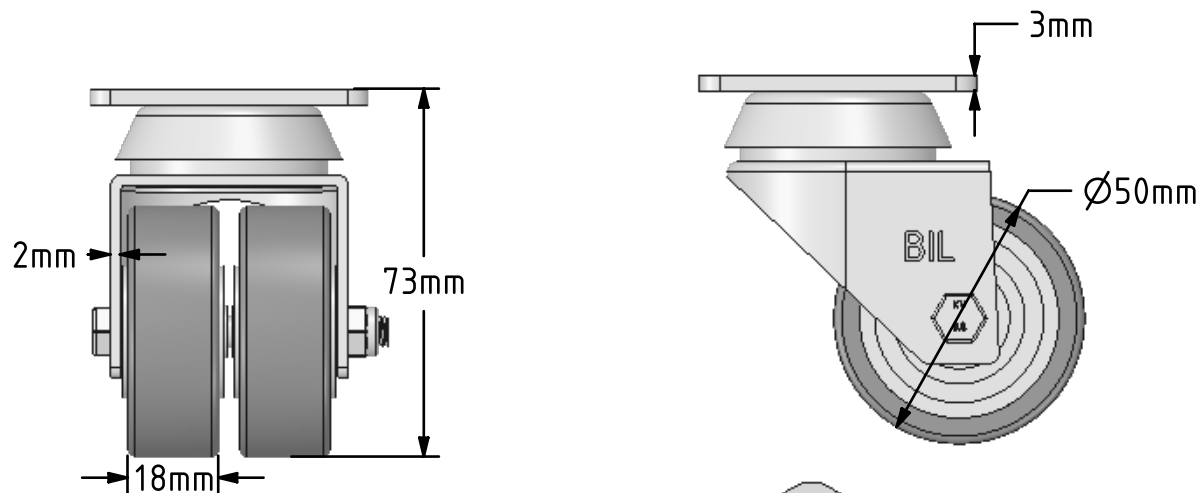
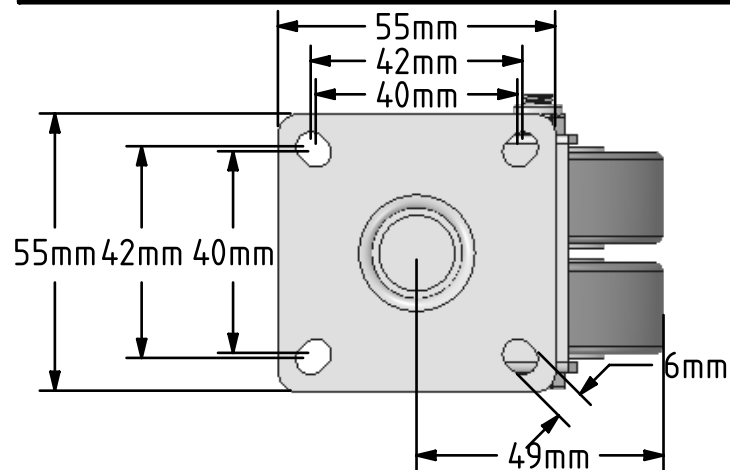

	NAME	DATE
DRAWN	Matt	21/11/17
APPROVED BY	Chris	21/11/17
SCALE	2:3	21/11/17
WEIGHT	0.335kg	21/11/17

UNLESS OTHERWISE SPECIFIED DIMENSIONS ARE IN MILLIMETRES

Unspecified Tolerances
 Machining ± 0.25mm
 Fabrication ± 1mm



BIL Group Ltd, Porte Marsh Road, Calne
 Wiltshire, SN11 9BW, United Kingdom
 Tel +44 (0)1249 822 222 Fax: +44 (0)1249 822 300
 www.bilgroup.co.uk

TITLE

2BZD50VGRBJ

SIZE DWG NO.

A4

BILCW032BZD50VGRBJ_01

REV

1

FILE NAME

BILCW032BZD50VGRBJ_01.PDF

SHEET 1 OF 1