

DRAWING DISCLAIMER
 COPYRIGHT OF THIS DRAWING IS RESERVED BY BIL GROUP LTD. IT IS ISSUED ON CONDITION THAT IT IS NOT REPRODUCED, COPIED, OR DISCLOSED TO A THIRD PARTY EITHER WHOLLY OR IN PART WITHOUT THE CONSENT IN WRITING OF BIL GROUP LTD.

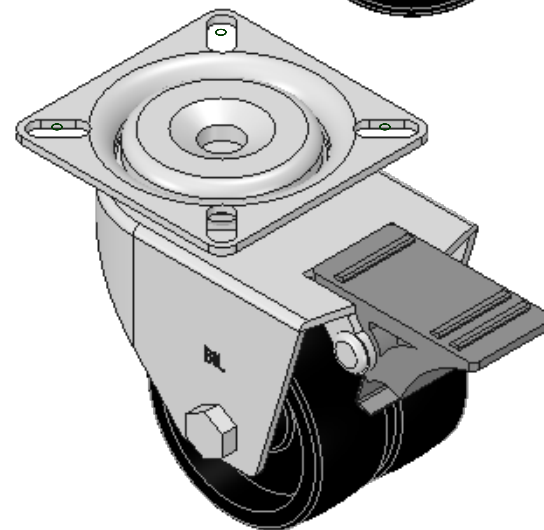

Description:
 2BZA50PLSWB

Twin wheeled pressed steel swivel castor with a top plate fixing fitted with 2 black polypropylene wheels with plain bearings and total lock brake. Wheel diameter 50mm, tread width 2 x 20mm, overall height 73mm, plate size 60mm x 60mm, hole centres 46mm x 46mm Load capacity 60kg.

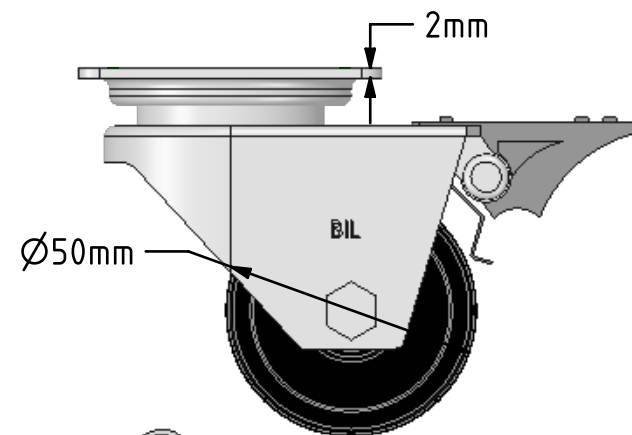
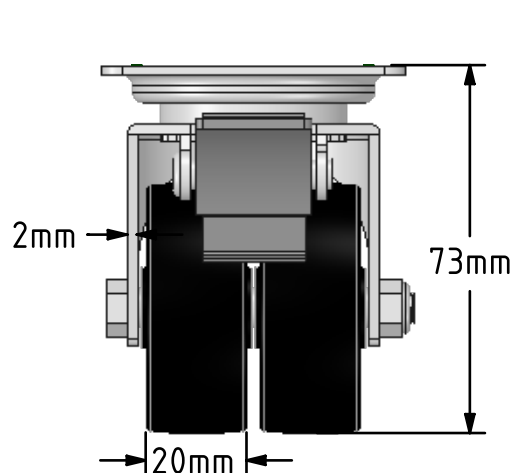
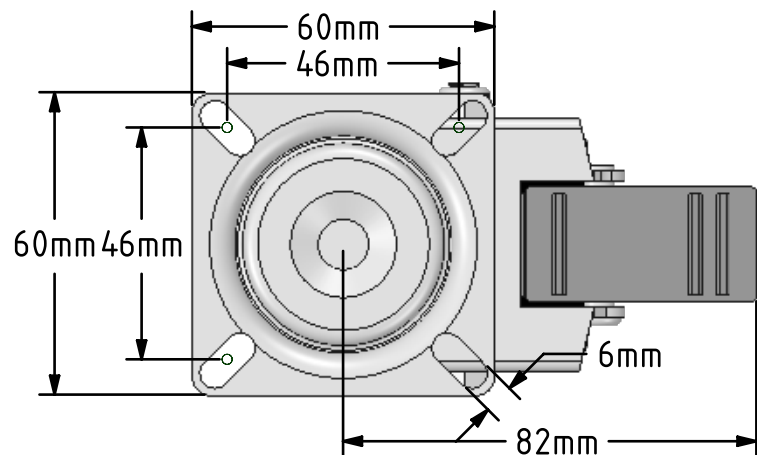

	NAME	DATE
DRAWN	Matt	12/07/18
APPROVED BY	Tim W	12/07/18
SCALE	2:3	12/07/18
WEIGHT	0.316kg	12/07/18

UNLESS OTHERWISE SPECIFIED DIMENSIONS ARE IN MILLIMETRES

Unspecified Tolerances
 Machining ± 0.25mm
 Fabrication ± 1mm



BIL Group Ltd, Porte Marsh Road, Calne
 Wiltshire, SN11 9BW, United Kingdom
 Tel +44 (0)1249 822 222 Fax: +44 (0)1249 822 300
 www.bilgroup.co.uk

TITLE

2BZA50PLSWB

SIZE DWG NO.

A4

BILCW032BZA50PLSWB__02

REV

2

FILE NAME BILCW032BZA50PLSWB__02.PDF

SHEET 1 OF 1