

ITEM NO.	PART NUMBER	QTY
1	BZJF150AS	1
2	BZH150WNYBJM2060	1
3	AXLE KIT	
	TH20X2X12	2
	HEXBOLTM12X90Z8.8	1
	NYLOCM12Z	1

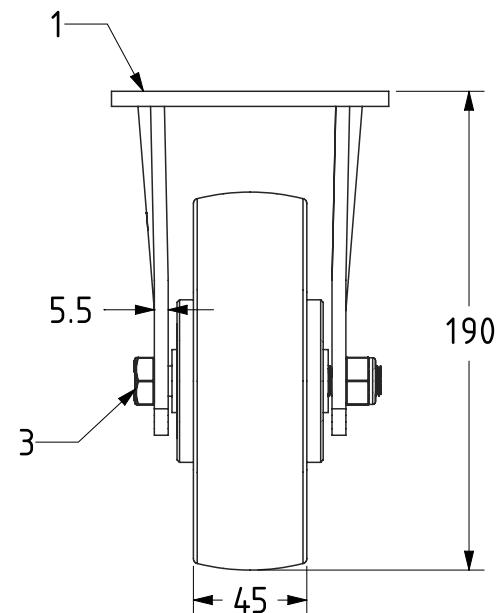

UNLESS OTHERWISE
SPECIFIED
DIMENSIONS ARE IN
MILLIMETRES

Unspecified Tolerances
Machining $\pm 0.25\text{mm}$
Fabrication $\pm 1\text{mm}$

DRAWING DISCLAIMER

COPYRIGHT OF THIS
DRAWING IS RESERVED BY
BIL GROUP LTD. IT IS ISSUED
ON CONDITION THAT IT IS
NOT REPRODUCED, COPIED,
OR DISCLOSED TO A THIRD
PARTY EITHER WHOLLY OR
IN PART WITHOUT THE
CONSENT IN WRITING OF BIL
GROUP LTD.

	NAME	DATE
DRAWN	Matt	19/05/22
APPROVED BY	Kevin	19/05/22
SCALE	1:3	
WEIGHT	2.136kg	



BIL Group Ltd, Porte Marsh Road, Calne
Wiltshire, SN11 9BW, United Kingdom
Tel +44 (0)1249 822 222 Fax: +44 (0)1249 822 300
www.bilgroup.co.uk

DWG NO.

BZJF150NYBJ

REV
1

BZJF150NYBJ

SHEET 1 OF 1