

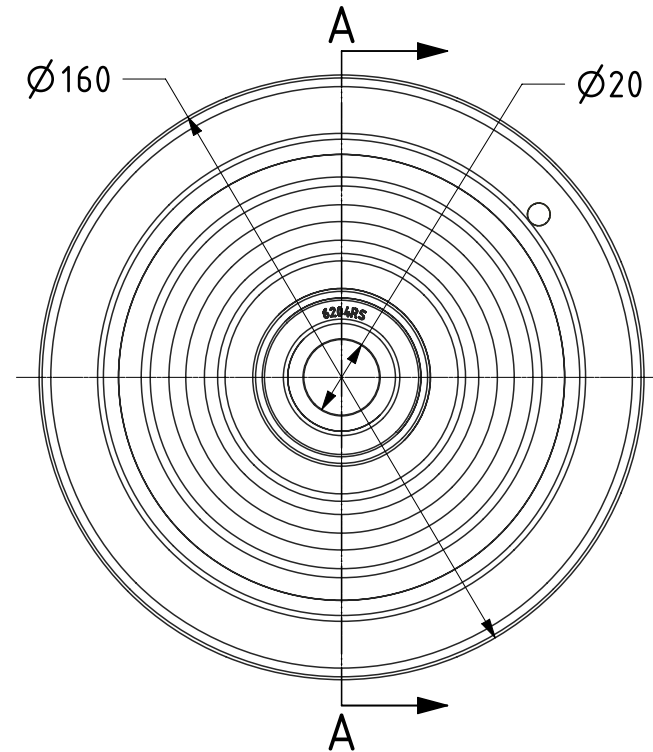

ITEM NO.	PART NUMBER	QTY
1	ELECTRICALLY CONDUCTIVE RUBBER TYRE	1
2	NYLON RIM	1
3	BEARING6204	2
4	BEARING SPACER	1

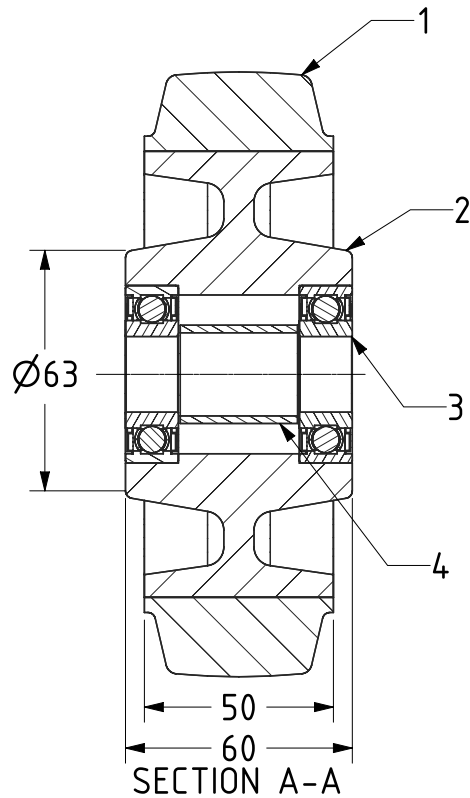

UNLESS OTHERWISE SPECIFIED DIMENSIONS ARE IN MILLIMETRES

Unspecified Tolerances  
Machining ± 0.25mm  
Fabrication ± 1mm

**DRAWING DISCLAIMER**

COPYRIGHT OF THIS DRAWING IS RESERVED BY BIL GROUP LTD. IT IS ISSUED ON CONDITION THAT IT IS NOT REPRODUCED, COPIED, OR DISCLOSED TO A THIRD PARTY EITHER WHOLLY OR IN PART WITHOUT THE CONSENT IN WRITING OF BIL GROUP LTD.

	NAME	DATE
DRAWN	Matt	22/03/23
APPROVED BY	Kevin	22/03/23
SCALE	1:2	
WEIGHT	1.098kg	

BIL Group Ltd,  
Porte Marsh Road,  
Calne, Wiltshire, SN11 9BW,  
United Kingdom  
Tel +44 (0)1249 822 222  
www.bilgroup.co.uk

DWG NO.	BZH160WRNBJM20EC	REV 1
BZH160WRNBJM20EC		SHEET 1 OF 1